

HAVALI LOKMA TAKIMI

3/8"	KISA	SS-72MB
6 p.	ALTIKÖŞE: 8-13mm	\$26,80

Kısa Lokma: m8-9-10-11-12-13

1/2"	KISA	GS-409M
9 p.	ALTIKÖŞE: 11-22mm	\$38,80

Uzun Lokma: m11-12-13-14-16-17-19-21-22

3/4"	KISA	CM-022 CM-608M
8 p.	ALTIKÖŞE: 26-38mm	\$107,60

Kısa Lokma: m26-27-29-30-32-35-36-38

3/4"	KISA	CM-021
8 p.	ALTIKÖŞE: 1"-1.1/2"	\$128,80

Kısa Lokma: 1"-1,1/16-1,1/8-1,1/4-1,5/16-1,3/8-1,7/16-1,1/2

1"	KISA	CM-110 CM-809M
9 p.	ALTIKÖŞE: 24-50mm	\$190,70

Kısa Lokma: m24-27-30-32-35-38-41-46-50

1"	KISA	CM-029
9 p.	ALTIKÖŞE: 1"-2"	\$239,30

Kısa Lokma: 1-1,1/8-1,1/4-1,3/8-1,1/2-1,5/8-1,3/4-1,7/8-2

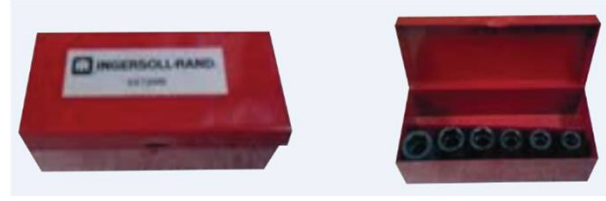

HAVALI LOKMA TAKIMI

1/2"	UZUN	TF-008-1 TD-410M1
10 p.	ALTIKÖŞE: 10-24mm	\$71,70

Uzun Lokma: m10-12-13-14-16-17-19-21-22-24

3/4"	UZUN	CM-608M4
8 p.	ALTIKÖŞE: 27-41mm KARE: 19-21mm	\$190,70

Uzun Lokma: m27-30-32-35-38-41

Uzun Kare lokma: m19-21



HAVALI LOKMA TAKIMI

1/2"	KISA	GS-417
17 p.	ALTIKÖŞE: 8-30mm	\$70,30
Kısa Lokma: m8-9-10-11-12-13-14-15-16-17-18-19-21-22-24-27-30		

3/4"	KISA	IS-609E
9 p.	ALTIKÖŞE: 19-36mm	\$117,10
Kısa Lokma: m19-22-24-27-30-32-33-34-36		

3/4"	KISA	IS-617E
17 p.	ALTIKÖŞE: 19-55mm	\$263,80
Kısa Lokma: m19-21-22-24-27-30-32-33-34-35-36-38-40-41 46-50-55		

3/4"	KISA	IS-617S
17 p.	ALTIKÖŞE: 1"-2"	\$327,90
Kısa Lokma: 1-1,11/16-1,1/8-1,3/16-1,1/4-1,5/16-1,3/8-1,7/16 1,1/2-1,9/16-1,5/8-1,11/16-1,3/4-1,13/16-1,7/8-1,15/16-2		

1"	KISA	IS-817S
17 p.	ALTIKÖŞE: 1.7/16-3.1/8	\$963,30
Kısa Lokma: 1,7/16-1,1/2-1,5/8-1,11/16-1,3/4-1,13/16-1,7/8 2"-2,1/8-2,3/16-2,1/4-2,3/8-2,1/2-2,5/8-2,3/4-2,15/16-3,1/8		



HAVALI LOKMA TAKIMI



3/4"	UZUN	DI-621M
21 p.	ALTIKÖŞE: 19-50mm	\$488,90
Uzun Lokma: m19-21-22-23-24-27-29-30-32-33-35-36-38-40 41-42-43-45-46-48-50		

HAVALI LOKMA TAKIMI



1/2"	KISA	TF-416M
16 p.	ALTIKÖŞE: 8-27mm	\$114,80
Kısa Lokma: m8-10-11-12-13-14-16-17-19-21-22-24-27		
Circir kol (1)-Mafsal kol (1)-Uzatma (1)		

ALTIKÖŞE KROMAJLI LOKMA TAKIMI



1/4"	KISA-UZUN	GS-244MS
44 p.	ALTIKÖŞE: 3-14mm ALTIKÖŞE: 3/16"-9/16"	\$70,20
Kısa Lokma: m3-4-5-5,5-6-7-8-9-10-11-12-143-14		
3/16-7/32-1/4-9/32-5/16-11/32-3/8-7/16-1/2-9/16		
Uzun Lokma: m5,5-6-7-8-9-10-11-12-13-14		
1/4-9/32-5/16-11/32-3/8-7/16-1/2-9/16		
Circir kol (1)-Uzatma (2)		

ALTIKÖŞE KROMAJLI LOKMA TAKIMI



1/4"	KISA	GS-219M
19 p.	ALTIKÖŞE: 4-12mm KARE: 8-10mm	\$49,90
Kısa Lokma: m4-4,5-5-5,5-6-7-8-9-10-11-12		
Kare Lokma: m8-10 Circir kol (1)		
T kolu (1)-Uzatma (2)-Lokma sapı -(1)-Ara mafsal (1)		

1/4"	KISA	GS-220M
20 p.	ALTIKÖŞE: 3-12mm KARE: 8-10mm	\$55,70
Kısa Lokma: m3-4-4,5-5-6-7-8-9-10-11-12		
Kare Lokma: m8-10 Circir kol (1)		
T kolu (1)-Uzatma (2)-Lokma sapı (1)-Ara mafsal (1)-Mafsal kol (1)		

ALTIKÖŞE KROMAJLI LOKMA TAKIMI



1/4"	KISA	GS-237S
37 p.	ALTIKÖŞE: 1/8"-9/16" KARE: 1/4"-3/8"	\$63,80
Kısa Lokma: 1/8-3/16-7/32-1/4-9/32-5/16-11/32-3/8-7/16		
1/2-9/16		
Kare lokma: 1/4-5/16-3/8		
Lokmalı düz uç (6)-Lokmalı Yıldız uç (4)-Lokmalı allen uç (8)		
T kolu (1)-Uzatma (1)-Lokma sapı (1)-Circir kol (1)-Ara mafsal (1)		

ALTIKÖŞE KROMAJLI LOKMA TAKIMI



1/4"	KISA-UZUN	GS-221M
21 p.	ALTIKÖŞE: 5-13mm	\$37,20
Kısa Lokma: m5-5,5-6-7-8-9-10-11-12-13		
Uzun Lokma: m6-7-8-9-10-11-12-13		
Circir kol (1)-Uzatma (1)-Lokma sapı (1)		

ALTIKÖŞE KROMAJLI LOKMA TAKIMI

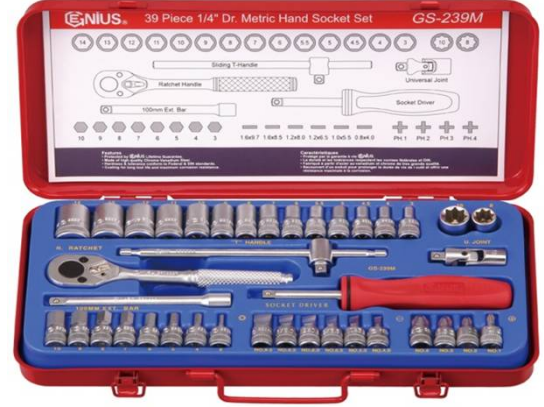

1/4"	KISA	GS-239M
39 p.	ALTIKÖŞE: 3-14mm KARE: 8-10mm	\$68,50
Kısa Lokma: m3-4-4,5-5-5,5-6-7-8-9-10-11-12-13-14		
Kare lokma: m8-10		
Lokmalı düz uç (6)-Lokmalı Yıldız uç (4)-Lokmalı allen uç (8)		
T kolu (1)-Uzatma (1)-Lokma sapı (1)-Circir kol (1)-Ara mafsals (1)		

ALTIKÖŞE KROMAJLI LOKMA TAKIMI



1/4"	KISA	EU-228M
28 p.	ALTIKÖŞE: 4-13mm	\$65,00
Kısa Lokma: m4-5-5,5-6-7-8-9-10-11-12-13		
Düz Uç:m4-6-7 Yıldız Uç:Ph1-2-3 Allen Uç:m3-4-5-6		
Bits uç adaptörü (1)		
T kolu (1)-Uzatma (2)-Lokma sapı (1)		
Mafsals (1)-Circir kol (1)-Ara mafsals (1)		

ALTIKÖŞE KROMAJLI LOKMA TAKIMI



1/4"	KISA-UZUN	GS-255MS
55 p.	ALTIKÖŞE: 3-14mm ALTIKÖŞE: 1/8"-9/16"	\$104,40
Kısa Lokma: m3-4-4,5-5-5,5-6-7-8-9-10-11-12-13-14		
1/8-3/16-7/32-1/4-9/32-5/16-11/32-3/8-7/16-1/2-9/16		
Uzun Lokma: m4-4,5-5-5,5-6-7-8-9-10-11-12-13-14		
3/16-7/32-1/4-9/32-5/16-11/32-3/8-7/16-1/2-9/16		
Uzatma (4)-Ara mafsals (1)-Adaptör (1)-Uç Ad.(1)		

1/4"	KISA	EU-228S
28 p.	ALTIKÖŞE: 1/8"-9/16"	\$69,60
Kısa Lokma: 1/8-3/16-7/32-1/4-9/32-5/16-11/32-3/8-7/16-1/2-9/16		
Düz Uç:m4-6-7 Yıldız Uç:Ph1-2-3 Allen Uç:1/8-5/32-3/16-7/32		
Bits uç adaptörü (1)		
T kolu (1)-Uzatma (2)-Lokma sapı (1)		
Mafsals (1)-Circir kol (1)-Ara mafsals (1)		

ALTIKÖŞE KROMAJLI LOKMA TAKIMI

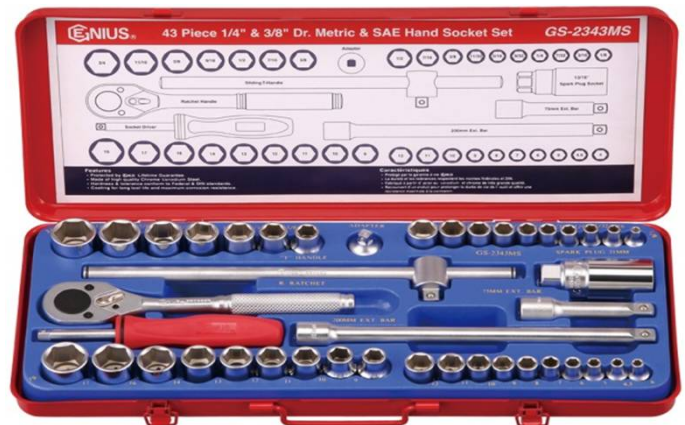

1/4" 3/8"	KISA	GS-2343MS
43 p.	ALTIKÖŞE: 4-19mm ALTIKÖŞE: 1/8"-3/4"	\$100,20
1/4" Kısa Lokma: m4-4,5-5-6-7-8-9-10-11-12		
1/8-3/16-7/32-1/4-9/32-5/16-11/32-3/8-7/16-1/2		
3/8" Kısa Lokma: m9-10-11-12-13-14-16-17-19		
3/8-7/16-1/2-9/16-5/8-11/16-3/4		
T kolu (1)-Uzatma (2)-Lokma sapı (1)		
Circir kol (1)-Adaptör (1)-Buji lokması (1)		

YILDIZ KROMAJLI LOKMA TAKIMI



3/8"	KISA-UZUN	AC-359
59 p.	YILDIZ: 6-22mm	\$113,50
Kısa Lokma: m6-7-8-9-10-11-12-13-14-15-16-17-18-19-20-21-22		
Uzun Lokma: m8-10-11-12-13-14-15-17-19		
Allen bits uç (6)-Yıldız bits uç (6)-Düz bits u (3)		
Delikli torx bits uç (9)-Uç adp.(1)		
Uzatma (2)-Bits uç sapı (1)-Circir kol (1)		
Adaptör (1)-Buji lokması (2)-Ara mafsal (1)		

ALTIKÖŞE KROMAJLI LOKMA TAKIMI



3/8"	KISA	GS-319M1
18 p.	ALTIKÖŞE: 6-21mm	\$77,40
Kısa Lokma: m6-7-8-10-11-12-13-14-15-16-17-19-21		
Circir kol (1)-Uzatma (2)-Buji lokması (1)-T kolu (1)		

ALTIKÖŞE KROMAJLI LOKMA TAKIMI



3/8"	KISA-UZUN	GS-347MS
47 p.	ALTIKÖŞE: 6-19mm ALTIKÖŞE: 1/4"/7/8"	\$126,80
Kısa Lokma: m6-7-8-9-10-11-12-13-14-15-16-17-18-19		
1/4-5/16-3/8-7/16-1/2-9/16-5/8-11/16-3/4-13/16-7/8		
Uzun Lokma: m10-11-12-13-14-15-16-17-18-19		
3/8-7/16-1/2-9/16-5/8-11/16-3/4-13/16-7/8		
Uzatma (2)-Circir kol (1)		

ALTIKÖŞE KROMAJLI LOKMA TAKIMI



3/8"	UZUN	GS-313M
13 p.	ALTIKÖŞE: 8-19mm	\$70,20
Uzun Lokma: m8-10-11-12-13-14-17-19		
Circir kol (1)-Uzatma (2)-Buji lokması (2)		

3/8"	UZUN	GS-313S
13 p.	ALTIKÖŞE: 5/16"-3/4"	\$88,10
Uzun Lokma: 5/16-3/8-7/16-1/2-9/16-5/8		
11/16-3/4 Circir kol (1)-Uzatma (2)-Buji lok.(2)		

YILDIZ KROMAJLI LOKMA TAKIMI

3/8"	UZUN	TW-316MD
16 p.	YILDIZ: 6-21mm	\$63,80
Uzun Lokma: m6-7-8-9-10-11-12-13-14-15-16-17-18-19-20-21		



ALTIKÖŞE KROMAJLI LOKMA TAKIMI

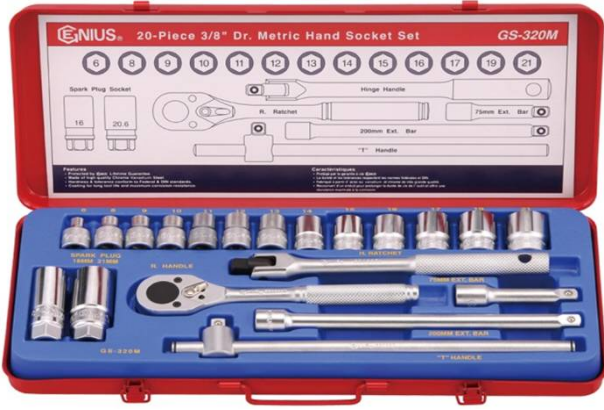

3/8"	KISA	GS-320M
20 p.	ALTIKÖŞE: 6-21mm	\$102,80
Kısa Lokma: m6-8-9-10-11-12-13-14-15-16-17-19-21		
Circir kol (1)-Uzatma (2)-T kolu (1)-Mafsal kol (1)-Buji lokması (2)		

3/8"	KISA	GS-320S
20 p.	ALTIKÖŞE: 1/4"-7/8"	\$104,10
Kısa Lokma: 1/4-5/16-3/8-7/16-1/2-9/16		
19/32-5/8-11/16-3/4-25/32-13/16-7/8		
Circir kol (1)-Uzatma (2)-T kolu (1)-Mafsal kol (1)-Buji lokması (2)		

3/8"	KISA-UZUN	GS-331M
31 p.	ALTIKÖŞE: 8-19mm	\$131,50
Kısa Lokma: m8-9-10-11-12-13-14-15-16-17-18-19		
Uzun Lokma: m8-9-10-11-12-13-14-15-16-17-18-19		
Uzatma (3)-Circir kol (1)-Mafsal kol (1)-Ara mafsal (1)		

ALTIKÖŞE KROMAJLI LOKMA TAKIMI



1/2"	KISA	EU-426M
26 p.	ALTIKÖŞE: 10-34mm	\$175,00
Kısa Lokma: m10-11-12-13-14-15-16-17-18-19-20-21-22-23-24		
26-27-28-30-32-34		
Circir kol (1)-Uzatma (2)-T kolu (1)-Ara mafsal (1)		

ALTIKÖŞE KROMAJLI LOKMA TAKIMI



3/8"	KISA	EU-319M
19 p.	ALTIKÖŞE: 8-22mm	\$98,20
Kısa Lokma: m8-9-10-11-12-13-14-15-16-17-19-21-22		
Circir kol (1)-Uzatma (3)-Ara mafsal (1)		

ALTIKÖŞE KROMAJLI LOKMA TAKIMI



YILDIZ KROMAJLI LOKMA TAKIMI



1/2"	KISA	EU-421S
21 p.	YILDIZ: 3/8"-1.1/4"	\$175,00
Kısa Lokma: 3/8-7/16-1/2-9/16-19/32-5/8-11/16-3/4-13/16		
7/8-15/16-1.1/16-1.1/8-1.3/16-1.1/4		
Circir kol (1)-Uzatma (2)-T kolu (1)-Ara mafsal (1)		

ALTIKÖŞE KROMAJLI LOKMA TAKIMI



1/2"	KISA	GS-417M
17 p.	ALTIKÖŞE: 10-32mm	\$97,60
Kısa Lokma: m10-11-12-13-14-15-17-19-22-24-27-30-32 Circir kol (1)-Uzatma (1)-T kolu (1)-Ara mafsal (1)		

1/2"	KISA	GS-417S
17 p.	ALTIKÖŞE: 3/8"-1.1/4"	\$124,20
Kısa Lokma: 3/8-7/16-1/2-9/16-5/8-11/16-3/4-13/16-7/8-15/16 1-1/8-1,1/4-13/16-7/8 Circir kol (1)-Uzatma (1)-T kolu (1)-Ara mafsal (1)		

ALTIKÖŞE KROMAJLI LOKMA TAKIMI



1/2"	KISA	GS-424M3
24 p.	ALTIKÖŞE: 10-32mm	\$134,60
Kısa Lokma: m10-11-12-13-14-15-16-17-18-19-21-22-23-24-27-30-32 Circir kol (1)-Uzatma (2)-T kolu (1)-Ara mafsal (1)-Mafsal kol (1) Buji lokması (1)		

1/2"	KISA	GS-424M4
24 p.	ALTIKÖŞE: 8-32mm	\$139,60
Kısa Lokma: m8-10-11-12-13-14-15-16-17-18-19-21-22-24-27-30-32 Circir kol (1)-Uzatma (2)-T kolu (1)-Ara mafsal (1)-Firdöndü (1)		

ALTIKÖŞE KROMAJLI LOKMA TAKIMI



1/2"	KISA	GS-422M
22 p.	ALTIKÖŞE: 9-32mm	\$117,40
Kısa Lokma: m9-10-12-13-14-15-16-17-18-19-21-23-25-26-29-32 Circir kol (1)-Uzatma (2)-T kolu (1)-Ara mafsal (1)-Buji lokması (1)		

1/2"	KISA	GS-422M2
22 p.	ALTIKÖŞE: 10-32mm	\$117,40
Kısa Lokma: m10-11-12-13-14-15-16-17-19-20-21-22-24-27-30-32 Circir kol (1)-Uzatma (2)-T kolu (1)-Ara mafsal (1)-Buji lokması (1)		

1/2"	KISA	GS-422M3
22 p.	ALTIKÖŞE: 8-32mm	\$117,40
Kısa Lokma: m8-10-11-12-13-14-15-16-17-18-19-22-24-27-30-32 Circir kol (1)-Uzatma (2)-T kolu (1)-Ara mafsal (1)-Buji lokması (1)		

1/2"	KISA	GS-422M4
22 p.	ALTIKÖŞE: 8-32mm	\$117,40
Kısa Lokma: m8-10-11-12-13-14-15-16-17-19-21-22-24-27-30-32 Circir kol (1)-Uzatma (2)-T kolu (1)-Ara mafsal (1)-Buji lokması (1)		

1/2"	KISA	GS-422S
22 p.	ALTIKÖŞE: 3/8"-1.1/4"	\$129,30
Kısa Lokma: 3/8-7/16-1/2-9/16-19/32-5/8-21/32-11/16-3/4-25/32 13/16-7/8-15/16-1,1/8-1,1/4 Circir kol (1)-Uzatma (2)-T kolu (1)-Ara mafsal (1)-Buji lokması (1)		

ALTIKÖŞE KROMAJLI LOKMA TAKIMI



ALTIKÖŞE KROMAJLI LOKMA TAKIMI



1/2"	KISA	GS-424S
24 p.	ALTIKÖŞE: 5/16"-1.1/4"	\$129,30
Kısa Lokma: 5/16-3/8-7/16-1/2-9/16-19/32-5/8-11/16-3/4 25/32-13/16-7/8-15/16-1-1,1/16-1,1/8-1,3/16-1,1/4 Circir kol (1)-Uzatma (2)-T kolu (1)-Ara mafsal (1)-Buji lokması (1)		

ALTIKÖŞE KROMAJLI LOKMA TAKIMI



1/2"	KISA	GS-425S
24 p.	ALTIKÖŞE: 5/16"-1.1/4"	\$129,30
Kısa Lokma: 5/16-3/8-7/16-1/2-9/16-19/32-5/8-11/16-3/4 25/32-13/16-7/8-15/16-1-1,1/16-1,1/8-1,3/16-1,1/4 Circir kol (1)-Uzatma (2)-Buji lokması (1)-Ara mafsal (1) Mafsal kol (1)		

ALTIKÖŞE KROMAJLI LOKMA TAKIMI



1/2"	KISA	GS-427M
27 p.	ALTIKÖŞE: 10-32mm	\$159,80
Kısa Lokma: m10-11-12-13-14-15-16-17-18-19-21-22-23-24-27 28-30-32 Circir kol (1)-Uzatma (2)-T kolu (1)-Ara mafsal (1)-Mafsal kol (1) Buji lokması (1)-Mafsal kol sapı (1)		

1/2"	KISA	GS-427S
27 p.	ALTIKÖŞE: 5/16"-1.1/4"	\$159,80
Kısa Lokma: 5/16-3/8-7/16-1/2-9/16-19/32-5/8-11/16-3/4 3/4-25/32-13/16-7/8-15/16-1-1,1/16-1,1/8-1,3/16-1,1/4 Circir kol (1)-Uzatma (2)-T kolu (1)-Ara mafsal (1)-Mafsal kol (1) Buji lokması (1)-Mafsal kol sapı (1)		

YILDIZ KROMAJLI LOKMA TAKIMI



1/2"	KISA	TW-424M
24 p.	YILDIZ: 8-32mm	\$117,20
Kısa Lokma: m8-9-10-11-12-13-14-15-16-17-18-19-21-22-24-27 30-32 Circir kol (1)-Uzatma (2)-T kolu (1)-Ara mafsal (1)-Buji lokması (1)		

1/2"	KISA	TW-424S
24 p.	YILDIZ: 5/16"-1.1/4"	\$117,20
Kısa Lokma: 5/16-3/8-7/16-1/2-9/16-19/32-5/8-11/16-3/4 25/32-13/16-7/8-15/16-1-1,1/16-1,1/8-1,3/16-1,1/4 Circir kol (1)-Uzatma (2)-T kolu (1)-Ara mafsal (1)-Buji lokması (1)		

YILDIZ KROMAJLI LOKMA TAKIMI

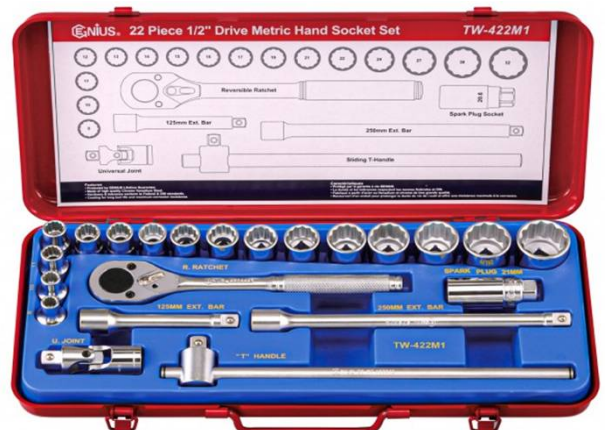

1/2"	KISA	TW-422M1
22 p.	YILDIZ: 8-32mm	\$117,20
Kısa Lokma: m8-10-11-12-13-14-15-16-17-19-21-22-24-27-30-32 Circir kol (1)-Uzatma (2)-T kolu (1)-Ara mafsal (1)-Buji lokması (1)		

ALTIKÖŞE KROMAJLI LOKMA TAKIMI

1/2"	KISA	GS-446MS
46 p.	ALTIKÖŞE: 8-32mm ALTIKÖŞE: 3/8"-1.1/4"	\$233,80
Kısa lokma: m8-9-10-11-12-13-14-15-16-17-18-19-20-21-22-23 24-25-26-27-28-30-32 3/8-7/16-1/2-9/16-5/8-11/16-3/4-13/16-7/8-15/16-1,1/8 1,3/16-1,1/4 Circir kol (1)-Uzatma (2)-Buji lokması (2)-Ara mafsal (1) Mafsal kol (1)-Mafsal kol sapı (1)-T kolu (1)		



ALTIKÖŞE KROMAJLI LOKMA TAKIMI

3/4"	KISA	EU-615M
15 p.	ALTIKÖŞE: 22-50mm	\$345,60
Kısa lokma: m22-24-27-30-32-33-34-36-41-46-50 Circir kol (1)T kolu (1)-Uzatma (2)		



ALTIKÖŞE KROMAJLI LOKMA TAKIMI

3/4"	KISA	GS-615M
15 p.	ALTIKÖŞE: 27-63mm	\$326,90
Kısa lokma: m27-30-32-33-35-36-38-41-46-50-55-60-63 T kolu (1)-Uzatma (1)		



3/4"	KISA	GS-615S
15 p.	ALTIKÖŞE: 1"-2.1/2"	\$326,90
Kısa Lokma: 1-1,1/8-1,1/4-1,3/8-1,1/2-1,5/8-1,3/4-1,7/8-2-2,1/8 2,1/4-2,3/8-2,1/2 T kolu (1)-Uzatma (1)		

ALTIKÖŞE KROMAJLI LOKMA TAKIMI

3/4"	KISA	GS-617M
17 p.	ALTIKÖŞE: 21-50mm	\$386,90
Kısa lokma: m21-22-23-24-27-30-32-35-36-38-41-46-50 Circir kol (1)T kolu (1)-Uzatma (2)		



3/4"	KISA	GS-617AS
17 p.	ALTIKÖŞE: 7/8"-2"	\$393,60
Kısa Lokma: 7/8-15/16-1,1/16-1,1/8-1,1/4-1,3/8-1,7/16-1,1/2 1,5/8-1,3/4-1,7/8-2 Circir kol (1)T kolu (1)-Uzatma (2)		

YILDIZ KROMAJLI LOKMA TAKIMI

3/4"	KISA	TW-617M
17 p.	YILDIZ: 21-50mm	\$393,60
Kısa lokma: m21-22-23-24-27-30-32-35-36-38-41-46-50		
Circir kol (1)T kolu (1)-Uzatma (2)		

3/4"	KISA	TW-617S
17 p.	YILDIZ: 7/8-2"	\$527,00
Kısa Lokma: 7/8-15/16-1-1,1/16-1,1/8-1,1/4-1,3/8-1,7/16-1,1/2		
1,5/8-1,3/4-1,7/8-2		
Circir kol (1)T kolu (1)-Uzatma (2)		



ALTIKÖŞE KROMAJLI LOKMA TAKIMI

3/4"	KISA	GS-627M
27 p.	ALTIKÖŞE: 17-60mm	\$416,30
Kısa lokma: m17-19-20-21-22-23-24-27-30-31-32-33-34-35-36-37-38		
40-41-45-46-48-50-54-55-57-60		

3/4"	KISA	GS-627S
27 p.	ALTIKÖŞE: 3/4"-2.3/8"	\$464,30
Kısa lokma: 3/4-25/32-13/16-7/8-15/16-1"-1,1/16-1,1/8-1,3/16-1,1/4		
1,5/16-1,3/8-1,7/16-1,1/2-1,9/16-1,5/8-1,11/16-1,3/4-1,13/16-1,7/8		
1,15/16-2"-2,1/16-2,1/8-2,3/16-2,1/4-2,3/8		



ALTIKÖŞE KROMAJLI LOKMA TAKIMI

1"	KISA	GS-816M
16 p.	ALTIKÖŞE: 36-80mm	\$920,50
Kısa lokma: m36-38-41-43-46-50-55-60-65-70-75-80		
Circir kol (1)-T kolu (1)-Uzatma (2)		

1"	KISA	GS-816M1
16 p.	ALTIKÖŞE: 36-80mm	\$920,50
Kısa lokma: m36-38-41-43-46-50-55-60-65-70-75-80		
Circir kol (1)-T kolu (1)-Uzatma (2)		

1"	KISA	GS-816M3
13 p.	ALTIKÖŞE: 41-80mm	\$867,10
Kısa lokma: m41-46-50-55-60-65-70-75-80		
Circir kol (1)-T kolu (1)-Uzatma (2)		

1"	KISA	GS-815S
15 p.	ALTIKÖŞE: 1.1/8"-2.1/2"	\$920,50
Kısa lokma: 1,1/8-1,1/4-1,3/8-1,1/2-1,5/8-1,3/4-1,7/8-2-2,1/8-2,1/4		
2,3/8-2,1/2		
Circir kol (1)-T kolu (1)-Uzatma (2)		



1"	KISA	GS-816S6
16 p.	ALTIKÖŞE: 1.7/16"-3.1/8"	\$1.053,90
Kısa lokma: 1,7/16-1,1/2-1,11/16-1,7/8-2-2,1/4-2,3/8-2,1/2		
2,5/8-2,3/4-2,15/16-3,1/8		
Circir kol (1)-T kolu (1)-Uzatma (2)		

ALTIKÖŞE KROMAJLI LOKMA TAKIMI

1"	KISA	GS-817M
17 p.	ALTIKÖŞE: 24-75mm	\$501,60
Kısa lokma: m24-27-30-32-33-35-36-38-41-46-50-54-55-60-65 70-75		

1"	KISA	GS-817S
17 p.	ALTIKÖŞE: 1.7/16"-3.1/8"	\$780,50
Kısa lokma: 1,7/16-1,1/2-1,5/8-1,11/16-1,3/4-1,13/16-1,7/8-2 2,1/8-2,3/16-2,1/4-2,3/8-2,1/2-2,5/8-2,3/4-2,15/16-3,1/8		



ALTIKÖŞE-YILDIZ KARIŞIK KROMAJLI LOKMA TAKIMI

3/4"	KISA	TW-628MS
28 p.	YILDIZ: 22-50mm ALTIKÖŞE: 7/8"-2"	\$509,60
Kısa yıldız lokma: m22-24-27-30-32-36-38-41-46-50 Kısa altıköşe lokma: 7/8-15/16-1-1,1/8-1,3/16-1,5/16-1,3/8 1,7/16-1,5/8-1,3/4-1,7/8-2 Circir kol (1)-T kolu (1)-Uzatma (2)-Mafsal kol (1)		



YILDIZ KROMAJLI LOKMA TAKIMI

1"	KISA	TW-816M1
16 p.	YILDIZ: 36-80mm	\$1.053,90
Kısa lokma: m36-38-41-43-46-50-55-60-65-70-75-80 Circir kol (1)-T kolu (1)-Uzatma (2)		



KROMAJLI TORX LOKMA TAKIMI

1/4"	KISA	TX-23414
3/8"		
1/2"		
14 p.		
TORX: E.4-E.24		
1/4" Kısa torx lokma: E.4-5-6-7-8 3/8" Kısa torx lokma: E.10-11-12-14-16 1/2" Kısa torx lokma: E.18-20-22-24		



KROMAJLI TORX LOKMA TAKIMI

1/2"	KISA	TX-409
9 p.	TORX: E.10-E.24	\$54,60
Kısa torx lokma: E.10-11-12-14-16-18-20-22-24		



KROMAJLI TORX LOKMA TAKIMI



1/4" 3/8"	KISA	TX-2319
19 p.	TORX: E.4-E.20	\$80,10
1/4" Kısa torx lokma: E.4-5-6-7-8-10-11		
3/8" Kısa torx lokma: E.10-11-12-14-16-18-20		
Circir kol (1)-Uzatma (2)-Adaptör (1)-Mafsallı lokma sapı (1)		

HAVALI ALTIKÖŞE LOKMALI ALLEN TAKIMI



3/8"	KISA	TH-310M
10 p.	ALTIKÖŞE: 4-17mm	\$73,00
Lokmalı Allen: m4-5-6-7-8-10-12-14-16-17		

3/8"	KISA	TH-310S
10 p.	ALTIKÖŞE: 5/32"-5/8"	\$83,00
Lok. Allen: 5/32-3/16-7/32-1/4-5/16-3/8-7/16-1/2-9/16-5/8		

HAVALI ALTIKÖŞE LOKMALI ALLEN TAKIMI



3/8"	KISA	TH-312M
12 p.	ALTIKÖŞE: 4-17mm	\$106,80
Lokmalı Allen: m4-5-6-7-8-10-12-14-16-17		
Circir kol (1)-T kolu (1)		

3/8"	KISA	TH-312S
12 p.	ALTIKÖŞE: 5/32"-5/8"	\$116,80
Lok. Allen: 5/32-3/16-7/32-1/4-5/16-3/8-7/16-1/2-9/16-5/8		
Circir kol (1)-T kolu (1)		

HAVALI LOKMALI TORX ALLEN TAKIMI



1/2"	KISA	TX-415
15 p.	TORX: T.7-T.70	\$155,00
Lokmalı Torx Allen: T.10-15-20-25-27-30-40-45-50-55-60-70		
Circir kol (1)-T kolu (1)-Uzatma (1)		

HAVALI ALTIKÖŞE LOKMALI ALLEN TAKIMI

1/2"	KISA	TH-408MD
8 p.	ALTIKÖŞE: 5-19mm	\$73,60
Lokmalı Allen: m5-6-8-10-12-14-17-19		



1/2"	KISA	TH-410S
10 p.	ALTIKÖŞE: 3/16"-3/4"	\$101,60
Lok. Allen: 3/16-7/32-1/4-5/16-3/8-7/16-1/2-9/16-5/8-3/4		

HAVALI ALTIKÖŞE LOKMALI ALLEN TAKIMI



1/2"	KISA	TH-412H
12 p.	ALTIKÖŞE: 5-19mm	\$121,20
Lokmalı Allen: m4-5-6-8-10-12-14-17-19 Circir kol (1)-T kolu (1)-Uzatma (1)		

1/2"	KISA	TH-412S
12 p.	ALTIKÖŞE: 5/32"-3/4"	\$132,40
Lokmalı Allen: 5/32-3/16-1/4-5/16-3/8-7/16-1/2-5/8-3/4 Circir kol (1)-T kolu (1)-Uzatma (1)		

HAVALI LOKMALI ALLEN TAKIMI



1/2"	KISA	TH-408M
8 p.	ALTIKÖŞE: 5-19mm	\$73,60
Lokmalı Allen: m5-6-8-10-12-14-17-19		

1/2"	KISA	TH-408S
8 p.	ALTIKÖŞE: 3/16"-3/4"	\$84,80
Lokmalı Allen: 3/16-1/4-5/16-3/8-7/16-9/16-11/16-3/4		

KROMAJLI ALTIKÖŞE LOKMALI ALLEN TAKIMI



1/2"	KISA	BS-409H
9 p.	ALTIKÖŞE: 4-17mm	\$45,30
Altıköşe lokmalı allen: m4-5-6-7-8-10-12-14-17 (80mm)		

KROMAJLI LOKMALI TORX ALLEN TAKIMI



1/2"	KISA	BS-409T
9 p.	TORX: T.20-T.60	\$56,30
Torx lokmalı allen: T.20-25-27-30-40-45-50-55-60 (80mm)		

TORX BİTS UÇ TAKIMI



1/4"-Arkalı 11.p	SB-711TP	\$7,00
Torx uç: T.6-7-8-9-10-15-20-25-27-30-40		

KROMAJLI TORX-YILDIZ-ALTIKÖŞE LOKMALI ALLEN TAKIMI



3/8" 1/2"	UZUN ALTIKÖŞE: 6-17mm TORX: T.55 YILDIZ: 8-12mm	TH-3416
16 p.		\$91,70
3/8" Altıköşe lokmalı allen: 6 (uzun)-6,7,8 (ex.uzun)		
3/8" Yıldız lokmalı allen: 8 (uzun)-10,12 (ex.uzun)		
1/2" Altıköşe lokmalı allen: 12,17 (kısa)-5,6,8,10 (uzun)		
6,8 (ex.uzun)		
1/2" Lokmalı torx allen: T.55 (uzun)		

BİTS UÇ TAKIMI



5/16"-Arkalı 33.p	SC-233	\$63,80
Allen uç: m3-4-5-6-7-8 (30mm)		
1/8-5/32-3/16-7/32-1/4-9/32-5/16 (30mm)		
Torx uç: T.10-15-20-25-27-30-40-45-50 (30mm)		
Düz uç: 5,5-5,6-7 (72mm)		
Yıldız uç: Ph1-2-3-4- (72mm)		
3/8" Uzatma (1)-3/8" Cırcır (1)-Bits uç adp.(1)		

KARIŞIK TORX TAKIMLAR



40.p	TX-23440	\$104,40
1/4" Dişi torx lokma: E.4-5-6-7-8		
3/8" Dişi torx lokma: E.10-12-14-16-18-20		
Torx allen: T.9-10-15-20-25-27-30-40-45-50-55-60-70		
1/4" Allen uç: T.9-10-15-20 (30mm)		
10mm Allen uç: T.25-27-30-40-45-50 (30mm)		
14mm Allen uç: T.55 (115mm)-60-70 (75mm)		
Bits uç adp. (3)		



10mm-Arkalı 40.p	TX-3440	\$51,20
10mm Allen uç: m4-5-6-7-8-10-12 (30mm)		
10mm Allen uç: m4-5-6-7-8-10-12 (75mm)		
10mm Torx uç: T.20-25-30-40-45-50-55 (30mm)		
10mm Torx uç: T.20-25-30-40-45-50-55 (75mm)		
10mm Yıldız uç: m5-6-8-10-12 (30mm)		
10mm Yıldız uç: m5-6-8-10-12 (75mm)		
Bits uç adp. (2)		



1/4" 3/8" 1/2" 41 p.	KISA TORX: T.7-T.70 E.4-E.20	BS-23441
\$184,50		
1/4" Torx lokma: E.4-5-6-7-8		
3/8" Torx lokma: E.10-11-12-14-16		
1/2" Torx lokma: E.18-20		
1/4" Lokmalı torx allen: T.7-8-9-10-15-20-25-27-30		
3/8" Lokmalı torx allen: T.40-45-50-55		
1/2" Lokmalı torx allen: T.60-70		
1/4" Lokmalı delikli torx allen: T.8-9-10-15-20-25-27-30		
3/8" Lokmalı delikli torx allen: T.40-45-50-55		
1/2" Lokmalı delikli torx allen: T.60-70		

BOMBE BAŞ ALTIKÖŞE ALLEN ANAHTAR TAKIMI



1,5-10mm 9.p	HK-009MB	\$23,20
m1,5-2-2,5-3-4-5-6-8-10		

1/16"-3/8" 9.p	HK-009SB	\$23,20
1/16-5/64-3/32-1/8-5/32-3/16-1/4-5/16-3/8		



1,5-10mm 9.p / Kromajlı	HK-09MBS	\$25,60
m1,5-2-2,5-3-4-5-6-8-10		

1/16"-3/8" 9.p / Kromajlı	HK-09SBS	\$25,60
1/16-5/64-3/32-1/8-5/32-3/16-1/4-5/16-3/8		

TORX ALLEN ANAHTAR TAKIMI



T.9-T.50 10.p	SK-010S	\$20,90
T.9-10-15-20-25-27-30-40-45-50		

UZUN TORX ALLEN ANAHTAR TAKIMI



T.9-T.50 10.p	SK-010L	\$23,20
T.9-10-15-20-25-27-30-40-45-50		

UZUN DELİKLİ TORX ALLEN ANAHTAR TAKIMI



T.9-T.50 10.p	SK-010T	\$25,60
T.9-10-15-20-25-27-30-40-45-50		

UZUN BOY TEK ALLEN ANAHTAR



Ölçü	Boy	
14mm	55x280mm	\$23,00
17mm	63x320mm	\$25,80
19mm	70x360mm	\$30,00

CIRCIRLI KOMBİNE ANAHTAR TAKIMI



8 -19mm 11.p	GW-7611M	\$137,90
m8-10-11-12-13-14-15-16-17-18-19		

5/16"-3/4" 8.p	GW-7708S	\$111,40
5/16-3/8-7/16-1/2-9/16-5/8-11/16-3/4		

CIRCIRLI KOMBİNE ANAHTAR TAKIMI



8 -19mm 7.p	WRGCM7	\$108,60
m8-10-12-13-14-17-19		

CIRCIRLI KOMBİNE ANAHTAR TAKIMI

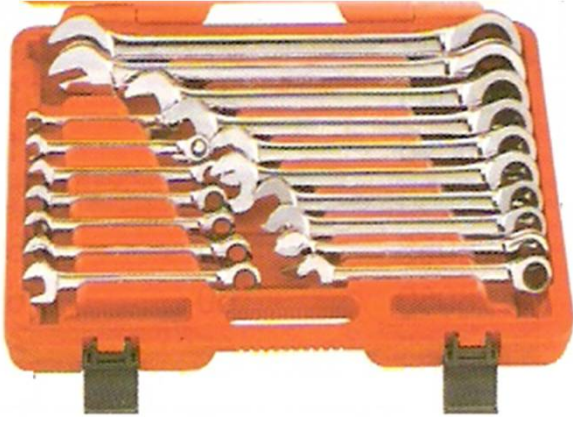

8-32mm 17.p	GW-7617M	\$371,40
m8-10-11-12-13-14-15-16-17-18-19-21-22-24-27-30-32		

KOMBİNE ANAHTAR TAKIMI



6-32mm 24.p	HS-024M	\$173,80
m6-7-8-9-10-11-12-13-14-15-16-17-18-19-20-21-22-23-24 25-26-27-30-32		

6-32mm 26.p	PR-026M	\$251,90
m6-7-8-9-10-11-12-13-14-15-16-17-18-19-20-21-22-23-24 25-26-27-28-29-30-32		

6-32mm 16.p	HS-016M	\$132,30
m6-7-8-9-10-11-12-13-14-17-19-22-24-27-30-32		

6-22mm 17.p	PR-017M	\$100,20
m6-7-8-9-10-11-12-13-14-15-16-17-18-19-20-21-22		

5/16"-1" 11.p	PR-011S	\$112,80
5/16-3/8-7/16-1/2-9/16-5/8-11/16-3/4-7/8-15/16-1"		

1/4"-1,1/4" 16.p	HS-016S	\$125,10
1/4-5/16-3/8-7/16-1/2-9/16-5/8-11/16-3/4-13/16-7/8 15/16-1,1/16-1,1/8-1,1/4		

1/4"-1,1/4" 16.p	PR-016S	\$154,40
1/4-5/16-3/8-7/16-1/2-9/16-5/8-11/16-3/4-13/16-7/8 15/16-1,1/16-1,1/8-1,1/4		

KOMBİNE ANAHTAR TAKIMI



7-19mm 11.p	HS-011M	\$48,80
m7-8-9-10-11-12-13-14-15-17-19		

1/4"-7/8" 11.p	HS-011S	\$71,00
1/4-5/16-3/8-7/16-1/2-9/16-5/8-11/16-3/4-13/16-7/8		

YILDIZ ANAHTAR TAKIMI

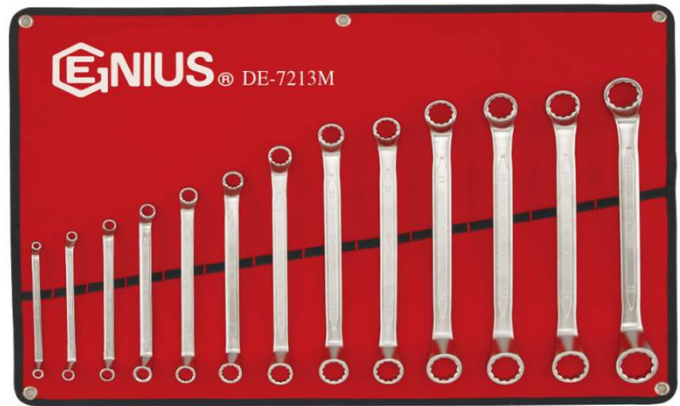

6-22mm MAT 8.p	DE-7208M	\$82,20
m6x7-8x9-10x11-12x13-14x15-16x17-18x19-20x22		

6-32mm MAT 13.p	DE-7213M	\$189,60
m6x7-8x9-10x11-12x13-14x15-16x17-18x19-20x22 21x23-24x26-25x28-27x29-30x32		

6-32mm 13.p	DE-713M	\$242,10
m6x7-8x9-10x11-12x13-14x15-16x17-18x19-20x22 21x23-24x26-25x28-27x29-30x32		

1/4"-1,1/8" 8.p	DE-708S	\$145,70
1/4x5/16-3/8x7/16-1/2x9/16-5/8x11/16-3/4x13/16 7/8x15/16-1x1,1/16-1,1/8x1,1/4		



İKİ AĞIZLI ANAHTAR TAKIMI



6-22mm 8.p	OW-708M	\$47,40
m6x7-8x9-10x11-12x13-14x15-16x17-18x19-20x22		

6-32mm 13.p	OW-713M	\$97,50
m6x7-8x9-10x11-12x13-14x15-16x17-18x19-20x22 21x23-24x26-25x28-27x30-30x32		

1/4"-1.1/4" 9.p	OW-709S	\$72,90
1/4x5/16-3/8x7/16-1/2x9/16-5/8x11/16-3/4x7/8 13/16x7/8-15/16x1-1x1.1/8-1.1/16x1.1/4		

TORX ANAHTAR TAKIMI



E.6-E.24 4.p	TX-E04	\$40,40
6x8-10x12-14x18-20x24		

TORX TORNAVİDA TAKIMI



T.6-T.50 13.p	TX-513T	\$55,70
T.6-7-8-9-10-15-20-25-27-30-40-45-50		

KOMBİNE ANAHTAR



Ölçü	Boy/mm	
24mm	320	\$12,60
27mm	370	\$16,80
28mm	360	\$17,40
30mm	410	\$19,50
32mm	430	\$20,90
34mm	461	\$29,30
36mm	486	\$39,30
38mm	486	\$46,00
41mm	540	\$49,80
46mm	611	\$56,30
50mm	611	\$64,80
55mm	666	\$154,20
60mm	760	\$202,60
65mm	760	\$202,60

CİRCİRLİ KOMBİNE ANAHTAR

Ölçü	Boy/mm	
8mm	135	\$9,30
9mm	142	\$9,40
10mm	158	\$10,20
11mm	167	\$10,20
12mm	173	\$11,10
13mm	179	\$11,40
14mm	189	\$12,00
15mm	199	\$12,30
16mm	215	\$13,50
17mm	232	\$13,50
18mm	238	\$14,00
19mm	247	\$15,00
20mm	285	\$22,70
21mm	285	\$23,30
22mm	285	\$23,30
24mm	325	\$28,80
27mm	359	\$36,50
30mm	425	\$44,70
32mm	425	\$44,70



Ölçü	Boy/mm	
17mm	128	\$13,50



MAFSALLI CİRCİRLİ KOMBİNE ANAHTAR

Ölçü	Boy/mm	
8mm	136	\$9,70
9mm	143	\$9,90
10mm	160	\$10,50
11mm	168	\$10,80
12mm	174	\$11,30
13mm	180	\$11,80
14mm	193	\$12,60
15mm	200	\$13,10
16mm	216	\$14,00
17mm	233	\$14,80
18mm	239	\$15,30
19mm	250	\$16,00
20mm	285	\$23,30
21mm	285	\$23,80
22mm	285	\$23,80
24mm	325	\$28,80
27mm	359	\$41,00
30mm	425	\$50,80
32mm	425	\$50,80



LOKMA TORNAVIDA TAKIMI

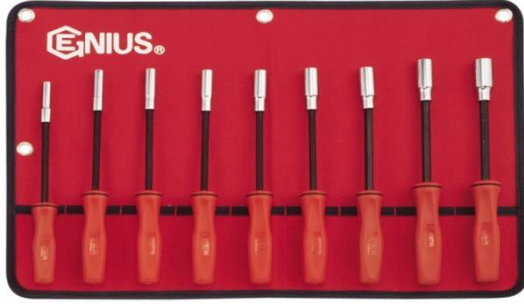

6-14mm 9.p	NM-009MD	\$89,40
m6-7-8-9-10-11-12-13-14		

1/4"-1/2" 6.p	NM-006SD	\$89,40
1/4-5/16-11/32-3/8-7/16-1/2		

SAATÇİ TORNAVIDA TAKIMI



6.P	TL-506	\$16,30
Düz:0,4x2-0,4x2,5-0,5x3		
Yıldız:Ph000-00-0		

6.P	TL-506A	\$16,30
Düz:0,3x1,2-0,3x1,6-0,4x2		
Yıldız:Ph000-00-0		

KOMPLE DARBELİ TORNAVIDA-LOKMA TAKIMI



1/2" - 24.P	ID-424S	\$168,60
1/2"Havalı lokma: 5/16-3/8-7/16-1/2-9/16-5/8-11/16		
3/4-13/16-7/8		
1/2"Havalı lokmalı altıköşe allen: 3/16-7/32-1/4-5/16-3/8		
1/2"Havalı lokmalı düz uç: 1,6x10-2x12-2,5x14-2,5x16		
1/2"Havalı lokmalı yıldız uç: Ph1-2-3-4		

BİTS UÇ TAKIMI



1/4"- Arkalı 34.p	SC-234A	\$32,50
Allen uç (6)-Düz uç (6)-Yıldız uç (3)-Torx uç (7)		
Delikli torx uç (7)-Kare uç (3)-Uç sapı (1)-Adptör (1)		

1/4"- Arkalı 37.p	SC-237M	\$32,50
Allen uç (6)-Düz uç (6)-Yıldız uç (6)-Torx uç (7)		
Delikli torx uç (7)-Yıldız allen uç (3)-Uç sapı (1)-Adptör (1)		

DARBELİ TORNAVIDA TAKIMI



1/2" - 6.P	TG-406B	\$33,70
5/16"Düz uç (2)-5/16"Yıldız uç (2)-Adaptör (1)		

DARBELİ TORNAVIDA



3/8"	700007	\$23,20
1/2"	700008	\$23,20

RULMAN ÇEKTİRME TABANI

30 - 50mm	XOR7202	\$37,60
50 - 75mm	XOR7203	\$58,50
75 - 105mm	XOR7204	\$91,90
105 - 150mm	XOR7205	\$188,00



İKİ AYAK ÇEKTİRME



75 x 75mm	KJ-2076	\$21,60
100 x 100mm	KJ-2102	\$30,90
125 x 125mm	KJ-2127	\$45,30
150 x 150mm	KJ-2152	\$53,30
200 x 200mm	KJ-2203	\$96,60
250 x 250mm	KJ-2254	\$150,20
300 x 300mm	KJ-2305	\$201,80

ÜÇ AYAK ÇEKTİRME



75 x 75mm	KJ-3076	\$32,10
100 x 100mm	KJ-3102	\$42,30
125 x 125mm	KJ-3127	\$56,30
150 x 150mm	KJ-3152	\$68,60
200 x 200mm	KJ-3203	\$148,30
250 x 250mm	KJ-3254	\$229,00
300 x 300mm	KJ-3305	\$311,50

İKİ AYAK ÇEKTİRME

120 x 30-80mm	KA-2080	\$52,70
120 x 30-120mm	KA-2120	\$59,80
160 x 40-160mm	KA-2160	\$94,90
200 x 40-200mm	KA-2200	\$104,40

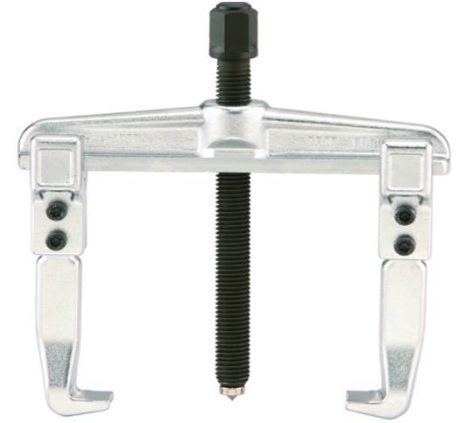

HİDROLİK İK-ÜÇ AYAK VE RULMAN ÇEKTİRME TAKIMI

Rulman 75 - 105mm 2-3 Ayak 100-150-200mm	XOR706C	\$494,20
Hidrolik mil (1) + Rulmak çekirtme tabanı (1)		
Rulman çekirtme gövdesi (1)		
Rulman çekirtme ayağı 200mm (2)		
2 ayak çekirtme gövdesi (1) + 3 ayak çekirtme gövdesi (1)		
2-3 ayak çekirtme ayağı 100mm (3)		
2-3 ayak çekirtme ayağı 150mm (3)		
2-3 ayak çekirtme ayağı 200mm (3)		



RULMAN ÇEKTİRME TAKIMI



30 - 75mm	XOR709	\$162,90
Rulmak çekirme tabanı (2) + Çektirme gövdesi (1) Çektirme ayağı 110mm (4) + 125mm (4)		
75 - 150mm	XOR709L	\$431,60
Rulmak çekirme tabanı (2) + Çektirme gövdesi (1) Çektirme ayağı 120mm (2) + 170mm (2) + 252mm (2)		

HİDROLİK RULMAN ÇEKTİRME TAKIMI



75 - 105mm	XOR706E	\$367,50
Hidrolik mil (1) + Rulmak çekirme tabanı (1) Çektirme gövdesi (1) + Çektirme ayağı 250mm (4)		

AYARLI PENSE



5" - 125mm	530305A	\$16,30
7" - 175mm	530307A	\$20,90
10" - 250mm	530310A	\$20,90

UZUN AĞIZLI TİP AYARLI PENSE



6" - 150mm	531306LN	\$15,40
------------	----------	---------

KAYNAKÇI TİPİ AYARLI PENSE



9" - 225mm	533309LW	\$29,30
------------	----------	---------

TERS KILAVUZ TAKIMI



No:1-6 6.p 3-25mm / 1/8"-1"	AT-EX6	\$10,50
-----------------------------------	--------	---------

ÜÇ AYAK (AHTAPOT) FİLTRE ANAHTARI



3/8"	65-110mm 2.1/2-4.5/16	AT-B01	\$17,70
------	--------------------------	--------	---------

AYARLI FİLTRE ANAHTARI



10"	53-118mm 2.1/8-4.5/8	AT-OF10A	\$26,50
-----	-------------------------	----------	---------

SAPLAMA SÖKECEK TAKIMI



6-12mm 4.p	FD-404M	\$47,60
m6-8-10-12		

FİLLER ÇAKISI (ÇAKI SENTİL)

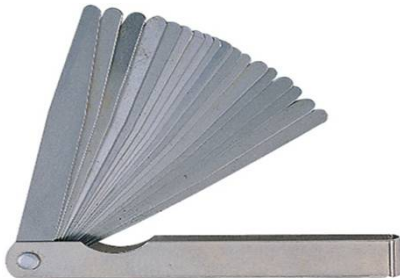

0,05-1,00mm 20 Yaprak	FG-020M	\$9,30
--------------------------	---------	--------

KESKİ ZIMBA TAKIMI



14.p	PC-514M	\$48,80
5 Keski-2 Nokta zimba-5 Pim zimba-2 Uzun pim zimba		

BUJİ LOKMALARI

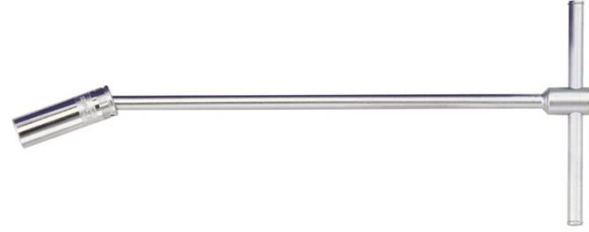

16mm (5/8") 380mm	4238016T	\$15,10
20,6mm (13/16") 380mm	4238021T	\$17,40



3/8"	16mm (5/8")	326016	\$8,20
3/8"	20,6mm (13/16")	326021	\$8,20
1/2"	16mm (5/8")	427016	\$9,30
1/2"	20,6mm (13/16")	427021	\$9,30

MEKANİK (EL) GRES POMPASI

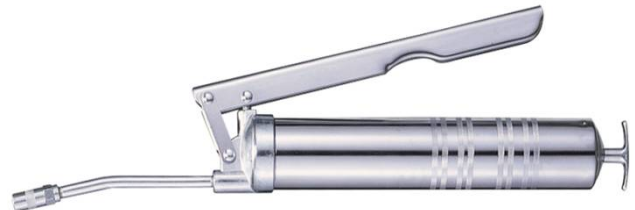

500cc	AT-46012	\$27,90
-------	----------	---------

MANYETİK STAND



305mm / 12"

005012

\$18,60

405mm / 16"

005016

\$22,00

LOKMA STANDI



1/4" - 410mm
15 Klips

010152

\$8,20

3/8" - 480mm
15 Klips

010153

\$8,20

1/2" - 560mm
15 Klips

010154

\$9,30

DÜZ İÇ SEGMAN PENSESİ



7" - 175mm

550751

\$22,10

EĞRİ İÇ SEGMAN PENSESİ



7" - 175mm

550753

\$22,10

İZOLELİ PENSE



7" - 175mm

551712D

\$22,60

DÜZ DIŞ SEGMAN PENSESİ



7" - 175mm

550750

\$22,10

İZOLELİ YANKESKİ



6" - 150mm

550607D

\$21,60

EĞRİ DIŞ SEGMAN PENSESİ



7" - 175mm

550752

\$22,10

İZOLELİ KARGABURUN



6" - 150mm

550604D

\$17,10

SAC MAKASI



10" - 250mm
Sağ

511002R

\$19,80

İZOLELİ FORT PENSE



10" - 250mm

551011D

\$27,40

KOLLU POP PERÇİN PENSESİ



SC-714

\$51,10

3,2 - 4 - 4,8 - 6,4mm

POP PERÇİN PENSESİ



SC-715

\$31,40

2,4 - 3,2 - 4 - 4,8mm

SOMUNLU PERÇİN PENSESİ



SC-758A

\$66,20

3 - 4 - 5 - 6mm

KOLLU SOMUNLU PERÇİN PENSESİ



SC-758M

\$192,60

5 - 6 - 8 - 10mm

ELMAS EĞE TAKIMI



FL-0785

\$32,50

200mm 5 Parçalı

KURBAĞACIK



4" - 100mm

780128

\$15,10

6" - 150mm

780192

\$15,10

8" - 200mm

780256

\$16,80

10" - 250mm

780320

\$22,30

12" - 300mm

780384

\$29,30

15" - 380mm

780480

\$59,40

18" - 450mm

780576

\$105,40

24" - 600mm

780692

\$219,30

BORU ANAHTARI



12" - 300mm

782300

\$38,30

14" - 350mm

782350

\$46,20

18" - 460mm

782460

\$65,10

24" - 600mm

782610

\$99,20

36" - 900mm

782910

\$153,60

48" - 1200mm

783220

\$344,80

AMORTİSÖR YAY ÇEKTİRME



300mm
3/8" Soketli

AT-SC230

\$75,40

TORKLU UZATMA TAKIMI



90-200nm
65-150ft.lb

TO-410EXT

\$226,20

FREN DİSK AYAR TAKIMI



AT-08

\$145,00

ROTBAŞI TAMİR TAKIMI (SÖKME)



AT-4808

\$75,40

HORTUM KELEPÇE PENSİ



220mm

AT-HC10

\$17,40

BALANS KURŞUNU ÇEKİCİ-PENSİ



250mm

560425

\$22,10

SEGMAN ÇEMBERİ



90-175mm
100mm Boy

PR-1755

\$16,30

SPİRALLİ MIKNATIS



AT-B24

\$15,10

Boy

600mm / 24"

Kapasite

1,60 Kg

TELESKOPIK MIKNATIS



AT-B16

\$11,60

Boy

645mm / 25,1/2"

Kapasite

1,60 Kg

TOPUKLU KEÇE LEVYESİ



561116

\$14,00

Boy

405mm

KOMPLE ÇANTALI EL ALETİ TAKIMI



151.p

AC-234151

\$506,70

1/4" Altıköşe kısa lokma: m4-5-5,5-6-7-8-9-10-11-12
1/8-3/16-7/32-1/4-9/32-5/16-11/32
1/4" Kısa dişli torx lokma: E.4-5-6-7-8-10
1/4" Kısa kare lokma: m8-10
3/8" Altıköşe kısa lokma: m13-14-15-16-17-18-19
3/8" Altıköşe uzun lokma: m8-9-10-12-13-14-15-16-17-18-19
3/8" Yıldız kısa lokma: 3/8-7/16-1/2-9/16-5/8-11/16-3/4-13/16-7/8
3/8" Kısa dişli torx lokma: E.12-14-16-18-20
1/2" Altıköşe kısa lokma: m20-21-22-24-27-30-32
1/2" Yıldız kısa lokma: 15/16-1,1/16-1,1/4
1/2" Altıköşe kısa havalı lokma: m17-18-19-21-22
1/4" Bits uçlar: Düz (4)-Yıldız (8)-Allen (6)-Torx (7)-D.torx (11)
Circir kol: 1/4 (1)-3/8 (1)-1/2 (1) Ara mafsali: 1/4 (1)-3/8 (1)-1/2 (1)
Uzatma: 1/4 (1)-3/8 (2)-1/2 (2) Buji lokması: 3/8 (2)
1/4" Lokma sapı-1/4" Uç sapı-1/4" Manyetik adp.
1/4" Uç adp.-Pense-Yankeski-Kargaburun
Allen anahtar: m1,5-2-2,5-3-4-5-6-8-10
Kombine anahtar: m8-9-10-11-12-13-14-15-16-17-18-19

KOMPLE ÇANTALI EL ALETİ TAKIMI



125.p

AC-234125

\$306,30

1/4" Altıköşe kısa lokma: m4-4,5-5-5,5-6-7-8-9-10-11-12-13
3/8" Altıköşe kısa lokma: m6-7-8-9-10-11-12-13-14-15-16-17-18-19
1/2" Altıköşe kısa lokma: m11-12-13-14-15-16-17-18-19-20-21-22-23-24-25-26-27
1/4" Bits uçlar: Düz (4)-Yıldız (8)-Allen (6)-Torx (7)-Robertson (3)
Circir kol: 3/8 (1)-1/2 (1) Uzatma: 1/4 (1)-3/8 (2)-1/2 (2)
1/4" Lokma sapı-1/4" Uç sapı-1/4" Manyetik adp. Buji lokması: 1/2 (2)
1/4" Uç adp.-Pense-Yankeski-Kargaburun
Allen anahtar: m1,5-2-2,5-3-4-5-6-8-10
Kombine anahtar: m6-7-8-9-10-11-12-13-14-15-16-17-19

KOMPLE ÇANTALI EL ALETİ TAKIMI



161.p

AC-234161R

\$522,00

1/4" Altıköşe kısa lokma: m4-4,5-5-5,5-6-7-8-9-10-11-12
1/8-3/16-7/32-1/4-9/32-5/16-11/32
1/4" Kısa dişli torx lokma: E.4-5-6-7-8-10
1/4" Altıköşe uzun lokma: m8-9-10-12-13-14
3/8" Altıköşe kısa lokma: m13-14-15-16-17-18-19
3/8" Yıldız kısa lokma: 3/8-7/16-1/2-9/16-5/8-11/16-3/4-13/16-7/8
3/8" Kısa dişli torx lokma: E.12-14-16-18-20
1/2" Altıköşe kısa lokma: m20-21-22-24-27-30-32
1/2" Yıldız kısa lokma: 15/16-1,1/16-1,1/4
1/2" Altıköşe uzun havalı lokma: m17-19-21
Circir kol: 1/4 (1)-3/8 (1)-1/2 (1) Ara mafsali: 1/4 (1)-3/8 (1)-1/2 (1)
Uzatma: 1/4 (2)-3/8 (1)-1/2 (2) Buji lokması: 3/8 (3)
1/4" Lokma sapı-1/4" Torn. için lokma adp. (3)-Uç sapı-1/4" Manyetik adp.
1/4" Lokma sapı-Pense-Yankeski-Kargaburun
1/4" S. Sıkma için uç adp.-1/4" Torn. için lokma adp. (3)-1/4" Manyetik adp.
1/4" Bits uçlar: Düz (6)-Yıldız (8)-Allen (8)-Torx (11)-D.torx (14)-Fare dş (3)
Allen anahtar: m1,5-2-2,5-3-4-5-6-8-10
Kombine anahtar: m8-9-10-11-12-13-14-15-16-17-18-19

ÇEKMECELİ TAKIM ARABASI



TS-798 \$986,00

7 Çekmeceli - Boş
670x460x813mm

TS-798/198P \$2.380,40

7 Çekmeceli -Dolu: 198 parça
670x460x813mm
MS-437M 37 P.Lokma seti
MS-007P 7 P.Pense seti
MS-008R 8 P.Filtre ve Segman pense seti
MS-019 19 P.Çekiç ve Keski seti
MS-020M 20 P.Kombine Anahtar seti
MS-020B 20 P.Açık ağız, Torx Yıldız an. seti
MS-086 86 P.Tornavida, Bitsuç ve Allen an.

ÇEKMECELİ TAKIM DOLABI



TS-790 \$665,10

10 Çekmeceli - Boş
660x455x483mm

ÇEKMECELİ TAKIM ARABASI MUHTEVİYATLARI



MS-437M \$261,00

37 P.Lokma seti
1/2" Altıköşe Lokma: 8-9-10-11-12-13-14-15-16
17-18-19-21-22-24-27-30-32-36
1/2" Torx Lokma: 10-11-12-14-16-18-20-22-24
1/2" Buji Lokması: 16-20,6
Uzatma (3)-Mafsal-Adaptör-Mafsal kol-Circir



MS-020M \$203,00

20 P.Kombine Anahtar seti
Kombine: m6-7-8-9-10-11-12-13-14-15-16-17
18-19-21-22-24-27-30-32



MS-007P \$154,30

7 P.Pense seti
Pense 180mm-Yankeski 180mm
Düz kargaburun 200mm-Eğri kargaburun 200mm
Ayarlı pense 250mm-Fort pense 250mm
Uzun burunlu ayarlı pense 150mm



MS-020B \$203,00

20 P.Açık ağız, Torx, Yıldız anahtar seti
Açık ağız: 6x7-8x9-10x11-12x13-14x15-16x17
18x19-20x22
Yıldız: 6x7-8x9-10x11-12x13-14x15-16x17
18x19-20x22
Torx: 6x8-10x12-14x18-20x24



MS-008R \$153,20

8 P.Filtre ve Segman pense seti



MS-086 \$228,60

86 P.Tornavida, Bits uç ve Allen anahtar
Düz torn.(4)-Delikli torx torn.(10)
Yıldız torn.(Ph 2-Pz 2)-Flex bits tutucu
Bits uç (44)-Manyetik bits tutucu
Bits uç sapı (3)-B.Baş allen an.takımı
Delikli torx allen an.takımı



MS-019 \$191,40

19 P.Çekiç ve Keski seti
Keski: 6x125-10x140-14x150-19x200-25x200
Nokta zımba: 3x60-5x70-6x75-8x80-9x85
Pim zımba: 2x100-3x125-4x140-5x60-6x200
8x200 - Çekiç (2)

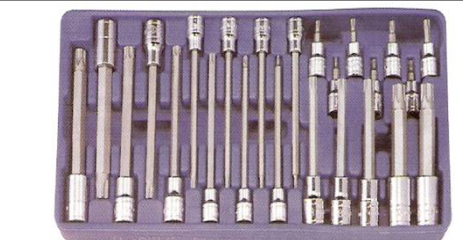

BS-3424T \$127,60

24 P.Lokmalı Torx allen seti
3/8"Lok.torx:T.10-15-20-25-27-30-40 (50mm)
3/8"Lok.torx:T.10-15-20-25-27-30-40 (140mm)
1/2"Lok.torx:T.45-50-55-60-70 (80mm)
1/2"Lok.torx:T.45-50-55-60-70 (150mm)

ÇEKMECELİ TAKIM ARABASI MUHTEVİYATLARI

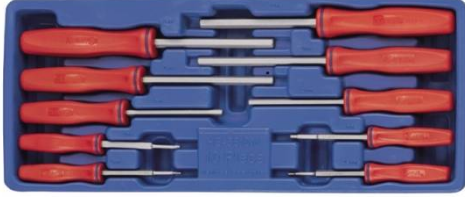

HS-5610M

\$55,70

10 P.Allen tornavida seti
m2-2,5-3-4-5-6-7-8-9-10

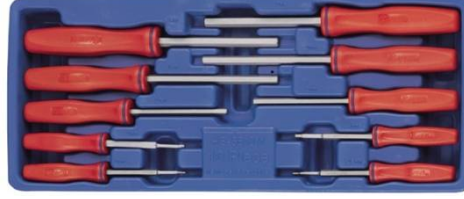

HS-5612S

\$55,70

12 P.Allen tornavida seti
1/16-5/64-3/32-7/64-1/8-5/32-3/16-7/32
1/4-9/32-5/16-3/8

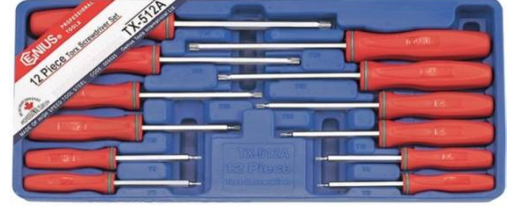

TX-512A

\$46,40

12 P.Delikli Torx tornavida seti
T.6-7-8-9-10-15-20-25-27-30-40-45

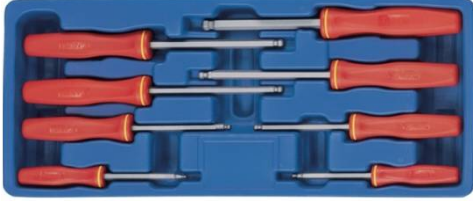

HS-5708MW

\$52,20

8 P.Bombe Başlı Allen tornavida seti
m3-4-5-6-7-8-9-10

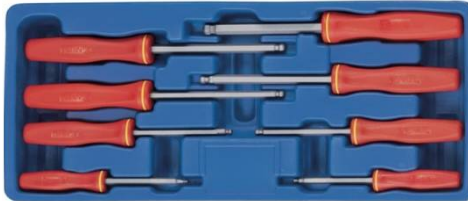

HS-5708SW

\$55,70

8 P.Bombe Başlı Allen tornavida seti
1/8-5/32-3/16-7/32-1/4-9/32-5/16-3/8

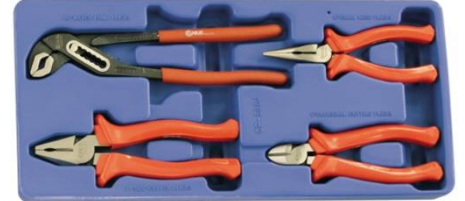

CP-5804

\$89,40

4 P.Pense seti
Pense 180mm-Kargaburun 150mm
Yankeski 150mm-Fort pense 250mm



MS-035MS

\$220,40

35 P.Pense,Kurbağacık,Allen,Çekiç ve Torn.seti
Düz torn.(5)-Yıldız torn.(Ph 5)-Pense 175mm
Yankeski 150mm-Düz kargaburun150mm
Fort pense 250mm-B.Baş allen an.takımı (2)
Kurbağacık 200mm-Ayarlı pense 175mm-Çekiç



MS-024M

\$232,00

24 P.Kombine,Yıldız anahtar seti
Kombine: m6-7-8-9-10-11-12-13-14-15-16-17
18-19-21-22
Yıldız: 6x7-8x9-10x11-12x13-14x15-16x17
18x19-20x22



OW-707M

\$38,30

7 P.Açığağz anahtar seti
6x7-8x9-10x11-12x13-14x15-16x17-18x19

TX-2324

\$107,20

24 P.Torx lokma ve bits uç seti
3/8" Torx lokma: E.10-11-12-14-16-18-20
1/4"Torx uç: T.8-10-15-20-25-27-30-40-45-50
İkiağz torx anahtar: 6x8-10x12-14x18-20x24
Bits uç adp. (3)



RP-5504

\$89,40

4 P.segman pense seti
Yaylı düz 180mm-Yaylı eğri 180mm
Yaysız düz 180mm-Yaysız eğri 180mm

TW-423M

\$141,60

23 P.Lokma seti
1/2" Yıldız Lokma: 8-10-11-12-13-14-15-16-17
18-19-21-22-23-24-27-30-32
Uzatma (2)-Mafsal-T kol-Cırcır



CIRCIRLI TORK ANAHTARLARI

280030N	1/4"	\$90,50
Boy / Kapasitesi	350mm / 6-30Nm	

380030N	3/8"	\$90,50
Boy / Kapasitesi	350mm / 6-30Nm	

380110N	3/8"	\$98,60
Boy / Kapasitesi	385mm / 19-110Nm	

480210N	1/2"	\$110,20
Boy / Kapasitesi	535mm / 40-210Nm	

480350N	1/2"	\$146,20
Boy / Kapasitesi	645mm / 70-350Nm	

680500N	3/4"	\$228,60
Boy / Kapasitesi	865mm / 100-500Nm	

680700N	3/4"	\$603,20
Boy / Kapasitesi	1092mm / 140-700Nm	

680980N	3/4"	\$751,70
Boy / Kapasitesi	1230mm / 140-980Nm	

880980N	1"	\$777,20
Boy / Kapasitesi	1230mm / 140-980Nm	

881500N	1"	\$1.389,70
Boy / Kapasitesi	1700mm / 300-1500Nm	

882000N	1"	\$1.844,40
Boy / Kapasitesi	2175mm / 400-2000Nm	



892000N	1"	\$1.844,40
Boy / Kapasitesi	2150mm / 400-2000Nm	

993000N	1.1/2"	\$2.192,40
Boy / Kapasitesi	2780mm / 600-3000Nm	

TO-227N	1/4"	\$150,80
Boy / Kapasitesi	150mm / 1-5nm	

Tornavida tipi tork anahtarı: 280005N
 30mmDüz tornavida ucu: m1x6-1x6,5-1,2x7
 30mmYıldız tornavida ucu: Ph1-2-3
 30mmAllen tornavida ucu: m3-4-5-6
 1/8-5/32-3/16-7/32-1/4
 30mmDelikli torx uc: T.10-15-20-25-27-30-40
 30mmYıldız (fare diş) tornavida ucu: m4-5-6
 Bits uç adaptörü:1/4-1/4



DEĞİŞKEN ANAHTAR AĞIZLI VE CIRCIR KAFALI TORK ANAHTAR TAKIMI



TO-312N11	\$191,40
Kapasitesi	19-110Nm
9x12mm Geçmeli Circir kafası (1)	
9x12mm Geçmeli Açık ağız anahtar ağızı (11)	
m.10,11,12,13,14,15,16,17,18,19	

TO-411N21	\$220,40
Kapasitesi	40-210Nm
14x18mm Geçmeli Circir kafası (1)	
14x18mm Geçmeli Açık ağız anahtar ağızı (9)	
m.13,14,15,17,19,22,24,27,30	

DEĞİŞKEN CIRCIR KAFALI TORK ANAHTARI



1434N10	\$406,00
Kapasitesi	10-100Nm
14x18mm Geçmeli Circir kafası 3/8"-1/2" (2)	

1434N20	\$452,40
Kapasitesi	20-200Nm
14x18mm Geçmeli Circir kafası 3/8"-1/2" (2)	

TORNAVİDA TİPİ TORK ANAHTARLARI

280045L	1/4"	\$127,60
Boy / Kapasitesi	150mm / 9-50in.lbs	

280005N	1/4"	\$127,60
Boy / Kapasitesi	150mm / 1-5nm	



TORK YÜKSELTİCİ



494008B \$1.038,20

Giriş	1/2" - Max:400nm
Çıkış	1" - Max:4000nm
Tur sayısı	10/1
Boy/mmu	
Ağırlığı	

"T" KOLLARI



1/4"	150mm	280020	\$4,50
3/8"	250mm	380030	\$7,40
1/2"	320mm	480040	\$11,90
3/4"	500mm	680060	\$26,70
1"	630mm	880063	\$93,40
1.1/2"	915mm	980090	\$169,50

"L" KOLLARI



1/2"	260mm	620260L	\$11,90
3/4"	330mm	620330L	\$20,10
3/4"	400mm	620400L	\$26,70

MAFSAL KOLLAR



3/8"	200mm	380336A	\$15,10
1/2"	380mm	480446A	\$26,70
3/4"	560mm	680446E	\$95,20
1"	815mm	880846E	\$130,80

LOKMA SAPI



1/4"	140mm	220150	\$4,90
------	-------	--------	--------

TORK YÜKSELTİCİ

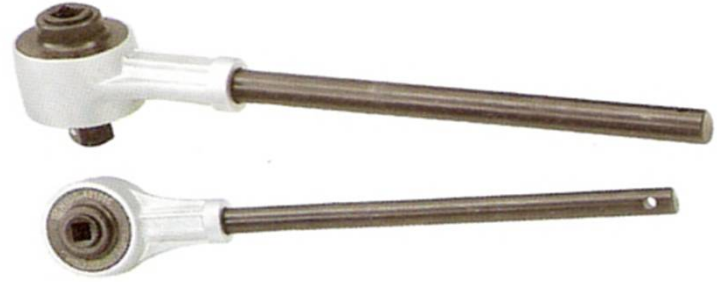

602000 \$510,40

Giriş	3/4" - Max:900nm
Çıkış	1" - Max:2700nm
Tur sayısı	3/1
Boy/mmu	500mm
Ağırlığı	4,75 Kg

CIRCIR KOLLAR



1/4"	Çevirmeli	280272	\$14,50
1/4"	Mandallı	280222R	\$19,00
3/8"	Çevirmeli	383372	\$20,30
3/8"	Mandallı	380333R	\$24,80
3/8"	Mandallı-Mafsal.	383363	\$53,80
1/2"	Çevirmeli	480472	\$21,90
1/2"	Mandallı	480444R	\$26,10
3/4"	Mandallı	680666R	\$72,50
1"	Mandallı	880888R	\$97,30

FIRDÖNDÜ KOL



3/8"	400mm	380400	\$12,70
1/2"	420mm	480420	\$20,90

BOMBE BAŞLI KROMAJLI UZATMALAR



1/2"	75mm	420003B	\$8,70
1/2"	125mm	420005B	\$11,90
1/2"	200mm	420008B	\$14,60
1/2"	250mm	420010B	\$16,30

HAVALI UZATMALAR



3/8"	75mm	340075B	\$5,80
3/8"	125mm	340125B	\$7,60
3/8"	150mm	380036	\$8,20
3/8"	200mm	340200B	\$13,40
1/2"	50mm	480030MB	\$14,00
1/2"	75mm	480032MB	\$6,80
1/2"	125mm	480036MB	\$7,50
1/2"	150mm	480150MB	\$8,30
1/2"	200mm	410008	\$9,90
1/2"	250mm	480250MB	\$26,70
3/4"	100mm	640100B	\$21,20
3/4"	150mm	640150B	\$25,40
3/4"	200mm	640200B	\$29,50
3/4"	250mm	640250B	\$34,20
1"	150mm	840150B	\$39,00
1"	200mm	841064B	\$52,30
1"	250mm	840250B	\$62,50
1"	400mm	840400B	\$124,80
1.1/2"	175mm	938175	\$727,10
1.1/2"	250mm	938250	\$862,70

KROMAJLI UZATMALAR



1/4"	100mm	220004	\$6,80
1/4"	150mm	220006	\$6,80
3/8"	75mm	320075	\$7,70
3/8"	150mm	320150	\$7,70
3/8"	200mm	320200	\$8,20
1/2"	75mm	424075	\$7,70
1/2"	125mm	424125	\$7,70
1/2"	250mm	424320	\$10,10
1/2"	200mm	424200	\$10,10
1/2"	300mm		\$10,10
3/4"	100mm	620100	\$16,80
3/4"	150mm	620150	\$16,80
3/4"	200mm	620200	\$16,80
3/4"	250mm	620250	\$16,80
3/4"	400mm	620400	\$30,10
1"	150mm	820150	\$31,00
1"	200mm	820200	\$31,00
1"	250mm	820250	\$31,00
1"	400mm	820400	\$75,20

HAVALI MAFSALLAR



1/4"	40mm	700106	\$14,00
3/8"	65mm	700107	\$14,00
1/2"	70mm	700108	\$15,80
3/4"	110mm	640606B	\$46,40
1"	130mm	840808B	\$105,00

KROMAJLI MAFSALLAR

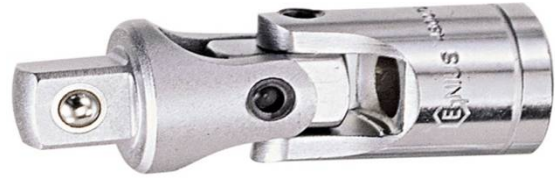

1/4"	40mm	280070	\$7,80
3/8"	54mm	380070	\$12,20
1/2"	78mm	480070	\$15,40
3/4"	110mm	680606	\$45,80
1"	130mm	880808	\$53,40

HAVALI ADAPTÖRLER



1/4-3/8	25mm	290030	\$3,50
3/8-1/4	30mm	380020	\$3,50
3/8-1/2	35mm	380040	\$4,30
1/2-3/8	38mm	480033MB	\$5,10
1/2-3/4	41mm	40066MB	\$9,50
3/4-1/2	63mm	640604B	\$17,50
3/4-1"	65mm	640608B	\$17,40
1"-3/4	70mm	841006B	\$21,90
1"-1.1/2	80mm	841012B	\$42,00
1.1/2-1"	98mm	938008	\$124,80
1.1/2-2.1/2	80mm	938020	\$525,50
2.1/2-1.1/2	98mm	920012	\$1.576,00

KROMAJLI ADAPTÖRLER



1/4-3/8	25mm	280030	\$6,20
3/8-1/2	35mm	320040	\$9,20
3/4-1/2	63mm	620604	\$15,40
3/4-1"	65mm	620608	\$18,40
1"-3/4	70mm	821006	\$18,40

ADAPTÖR KARESİ

1/2"	\$6,20
3/4"	\$13,40
1"	\$40,10



HAVALI ALTİKÖŞE LOKMALI ALLENLER



3/8"

5mm	52mm	345205	\$6,30
6mm	52mm	345206	\$6,30
7mm	52mm	345207	\$6,30
8mm	52mm	345208	\$6,30
10mm	52mm	345210	\$6,30
3/16	52mm	365206	\$7,30
7/32	52mm	365207	\$7,30
1/4	52mm	365208	\$7,30
5/16	52mm	265210	\$7,30
3/8	52mm	365212	\$7,30

1/2"

4mm	60mm	446004	\$7,00
5mm	60mm	446005	\$7,00
6mm	60mm	446006	\$7,00
7mm	60mm	446007	\$7,80
8mm	60mm	446008	\$7,80
10mm	60mm	446010	\$7,80
12mm	60mm	446012	\$7,80
14mm	60mm	446014	\$8,00
17mm	60mm	446017	\$8,50
19mm	60mm	446019	\$9,70
5/32	60mm	466005	\$7,90
3/16	60mm	466006	\$7,90
7/32	60mm	466007	\$8,40
1/4	60mm	466008	\$8,40
5/16	60mm	466010	\$8,40
3/8	60mm	466012	\$8,40
7/16	60mm	466014	\$8,40
1/2	60mm	466016	\$8,40
9/16	60mm	466018	\$9,30
5/8	60mm	466020	\$12,00
11/16	60mm	466022	\$12,00
3/4	60mm	466024	\$12,00

3/4"

14mm	80mm	619+2914	\$26,30
17mm	80mm	619+2917	\$26,30
19mm	88mm	619+2919	\$26,30
21mm	88mm	648821	\$26,30
22mm	88mm	622+2922	\$26,30
24mm	88mm	622+2924	\$28,00
27mm	88mm	627+2927	\$28,00
30mm	88mm	627+2930	\$28,00
32mm	88mm	627+2932	\$30,70

1"

17mm	85mm	819+2917	\$30,70
19mm	98mm	819+2919	\$30,70
21mm	98mm	849821	\$30,70
22mm	98mm	822+2922	\$30,70
24mm	98mm	822+2924	\$32,40
27mm	98mm	827+2927	\$32,40
30mm	98mm	827+2930	\$35,00
32mm	98mm	827+2932	\$35,00
33mm	98mm	832+2933	\$36,80
36mm	98mm	832+2936	\$36,80

HAVALI LOKMALI TORX ALLENLER



1/2"

T.30	60mm	4460S30	\$8,20
T.40	60mm	4460S40	\$8,20
T.70	60mm	4460S70	\$9,70

HAVALI LOKMALI DÜZ TORNAVIDA UÇLARI



3/8"

1x5,5	52mm	3452P055	\$7,10
1,2x8	52mm	3452P08	\$7,10
1,6x10	52mm	3452P10	\$7,10

1/2"

1,6x10	60mm	4460P10	\$7,10
2x12	60mm	4460P12	\$7,10
2,5x14	60mm	4460P14	\$7,10
2,5x16	60mm	4460P16	\$7,10

HAVALI LOKMALI YILDIZ TORNAVIDA UÇLARI



3/8"

Ph1	52mm	3452R01	\$7,10
Ph2	52mm	3452R02	\$7,10
Ph3	52mm	3452R03	\$7,10
Ph4	52mm	3452R04	\$7,10

1/2"

Ph1	60mm	4460R01	\$7,10
Ph2	60mm	4460R02	\$7,10
Ph3	60mm	4460R03	\$7,10
Ph4	60mm	4460R04	\$7,10



KROMAJLI KISA ALTIKÖŞE LOKMALI ALLENLER



1/4"

2mm	26mm	232802	\$4,30
2,5mm	26mm	208+2125	\$4,30
3mm	26mm	232803	\$4,30
4mm	26mm	232804	\$4,30
5mm	26mm	232805	\$4,30
6mm	26mm	232806	\$4,30
7mm	26mm	232807	\$4,30
8mm	26mm	232808	\$4,30
9mm	26mm	232809	\$4,30
10mm	26mm	232810	\$4,30
1/16	45mm	208+3104	\$6,40
5/64	45mm	208+3105	\$6,40
3/32	45mm	208+3106	\$6,40
7/64	45mm	208+3107	\$6,40
1/8	45mm	208+3108	\$6,40
5/32	45mm	208+3110	\$6,40
3/16	45mm	208+3112	\$6,40
7/32	45mm	208+3114	\$6,40
1/4	26mm	272808	\$6,40
9/32	26mm	272809	\$6,40
5/16	26mm	272810	\$6,40
3/8	26mm	272812	\$6,40

3/8"

3mm	50mm	308+2133	\$4,80
4mm	50mm	308+2134	\$4,80
5mm	50mm	308+2135	\$4,80
6mm	50mm	308+2136	\$4,80
7mm	50mm	310+2147	\$5,80
8mm	50mm	310+2148	\$5,80
9mm	50mm	339+2149	\$6,40
10mm	50mm	340+2150	\$6,40
9/32	50mm	310+3128	\$7,70
5/16	50mm	310+3130	\$7,70
3/8	50mm	312+3134	\$7,70
7/16	50mm	314+3138	\$7,70
1/2	50mm	316+3142	\$7,70

1/2"

4mm	55mm	408+2134	\$4,80
5mm	55mm	408+2135	\$4,80
6mm	55mm	408+2136	\$4,80
7mm	55mm	410+2147	\$5,80
8mm	55mm	410+2148	\$5,80
9mm	55mm	439+2149	\$6,40
10mm	55mm	440+2150	\$6,40
12mm	55mm	442+2152	\$7,10
3/16	55mm	408+3112	\$7,90
7/32	55mm	408+3114	\$8,40
1/4	55mm	408+3116	\$8,40
5/16	55mm	410+3130	\$8,40
3/8	55mm	412+3134	\$8,40
7/16	55mm	414+3138	\$8,40
1/2	55mm	416+3142	\$8,40

KROMAJLI UZUN ALTIKÖŞE LOKMALI ALLENLER

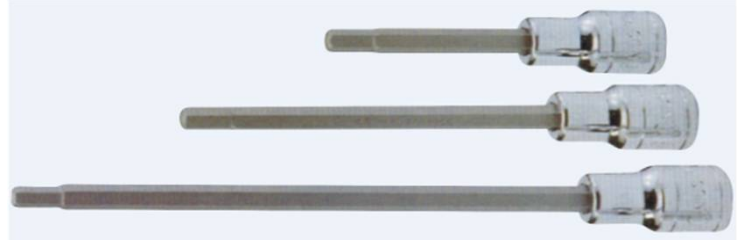

1/4"

1/16	100mm	208+3504	\$11,00
5/64	100mm	208+3505	\$11,00
3/32	100mm	208+3506	\$11,00
7/64	100mm	208+3507	\$11,00
1/8	100mm	208+3508	\$11,00
5/32	100mm	208+3510	\$11,00
3/16	100mm	208+3512	\$11,00
7/32	100mm	208+3514	\$11,00
1/4	100mm	208+3516	\$11,00

3/8"

9/32	110mm	310+3518	\$11,00
5/16	110mm	310+3520	\$11,00
3/8	110mm	312+3524	\$11,00
7/16	110mm	314+3528	\$11,00
1/2	110mm	316+3532	\$11,00

1/2"

5mm	110mm	408+2535	\$6,70
6mm	110mm	408+2536	\$6,70
8mm	110mm	410+2548	\$7,40
10mm	150mm	440+2650	\$7,60
14mm	80mm	444+2354	\$8,40
17mm	80mm	447+2357	\$10,10
17mm	150mm	447+2657	\$15,70
19mm	150mm	449+2659	\$17,40
9/16	80mm	418+3336	\$9,00
5/8	80mm	420+3340	\$10,30
3/4	80mm	424+3348	\$11,50

KROMAJLI UZUN ALTIKÖŞE BOMBE BAŞLI LOKMALI ALLENLER

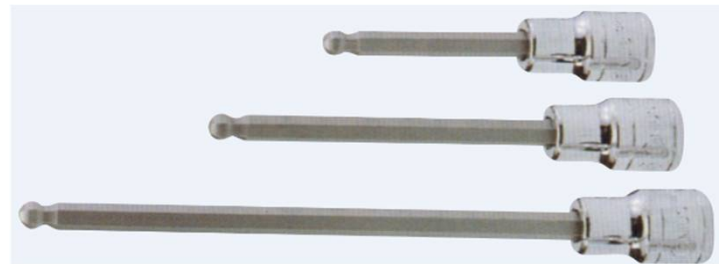

1/2"

6mm	230mm	408+4836	\$10,30
8mm	230mm	410+4848	\$10,30

KROMAJLI KISA LOKMALI TORX ALLENLER



1/2"

Model	Boy (mm)	Part No.	Fiyat (\$)
T-20	55mm	408+6120	\$5,80
T-25	55mm	408+6125	\$5,80
T-27	55mm	408+6127	\$5,80
T-30	55mm	408+6130	\$5,80
T-40	55mm	408+6140	\$6,30
T-45	55mm	410+6245	\$6,30
T-50	55mm	410+6250	\$7,10
T-55	55mm	440+6255	\$7,40

KROMAJLI LOKMALI DELİKLİ TORX ALLENLER



1/2"

Model	Boy (mm)	Part No.	Fiyat (\$)
T-20	55mm	408+7120	\$5,80
T-25	55mm	408+7125	\$5,80
T-27	55mm	408+7127	\$5,80
T-30	55mm	408+7130	\$5,80
T-40	55mm	408+7140	\$7,10
T-45	55mm	410+7145	\$7,10
T-50	55mm	410+7150	\$7,70
T-55	55mm	440+7155	\$8,40
T-60	60mm	442+7160	\$9,70
T-70	60mm	444+7170	\$9,70

KROMAJLI UZUN LOKMALI TORX ALLENLER



1/4"

Model	Boy (mm)	Part No.	Fiyat (\$)
T-06	100mm	208+6506	\$11,00
T-07	100mm	208+6507	\$11,00
T-08	100mm	208+6508	\$11,00
T-09	100mm	208+6509	\$11,00
T-10	100mm	208+6510	\$11,00
T-15	100mm	208+6515	\$11,00
T-20	100mm	208+6520	\$11,00
T-25	100mm	208+6525	\$11,00
T-27	100mm	208+6527	\$11,00
T-30	100mm	208+6530	\$11,00
T-40	100mm	208+6540	\$11,00

3/8"

Model	Boy (mm)	Part No.	Fiyat (\$)
T-45	110mm	310+6545	\$11,00
T-50	110mm	310+6550	\$11,00
T-55	110mm	310+6555	\$11,00

1/4" SOKETLİ KARE LOKMALAR



Ölçü (mm)	Boy (mm)	KISA Fiyat (\$)
8	25	\$5,50
10	25	\$5,50

KROMAJLI UZUN LOKMALI DELİKLİ TORX ALLENLER



1/2"

Model	Boy (mm)	Part No.	Fiyat (\$)
T-30	80mm	408+7330	\$9,30
T-40	80mm	408+7340	\$9,30

KROMAJLI LOKMALI YILDIZ TORNAVİDA UÇLARI



1/4"

Model	Boy (mm)	Part No.	Fiyat (\$)
Ph1	26mm	222601	\$4,70
Ph2	26mm	222602	\$4,70
Ph3	26mm	222603	\$4,70
Ph4	26mm	222604	\$4,70

KROMAJLI LOKMALI DÜZ TORNAVİDA UÇLARI



1/4"

Model	Boy (mm)	Part No.	Fiyat (\$)
0,8x4	26mm	222640	\$4,50
1x5,5	26mm	222655	\$4,50
1,2x6,5	26mm	222665	\$4,50
1,2x8	26mm	222680	\$4,50
1,6x10	26mm	222695	\$4,50

KROMAJLI TORX LOKMALAR

1/4"

Ölçü Ftx	Boy mm	KISA
E.4	22	\$4,60
E.5	22	\$4,60
E.6	22	\$4,60
E.7	22	\$4,60
E.8	22	\$4,60
E.10	22	\$4,60



3/8"

Ölçü Ftx	Boy mm	KISA
E.10	28	\$6,20
E.11	28	\$6,20
E.12	28	\$6,20
E.14	28	\$6,20
E.16	28	\$6,20
E.18	28	\$6,20
E.20	28	\$6,20

1/2"

Ölçü Ftx	Boy mm	KISA
E.10	38	\$8,20
E.11	38	\$8,20
E.12	38	\$8,20
E.14	38	\$8,20
E.16	38	\$8,20
E.18	40	\$8,20
E.20	40	\$8,20
E.22	40	\$8,20
E.24	40	\$8,20

HAVALI TORX LOKMALAR

1/2"

Ölçü Ftx	Boy mm	KISA
E.8	38	\$5,60
E.10	38	\$5,60
E.11	38	\$5,60
E.12	38	\$5,60
E.14	38	\$5,60
E.16	38	\$5,60
E.18	40	\$6,30
E.20	40	\$6,70
E.22	40	\$7,20
E.24	40	\$7,50
E.26	44	\$12,50
E.28	44	\$12,50
E.30	46	\$12,50
E.32	46	\$12,50



3/4"

Ölçü Ftx	Boy mm	KISA
E.20	50	\$29,40
E.22	50	\$29,40
E.24	50	\$29,40

3/8" SOKETLİ ALTİKÖŞE HAVALI LOKMALAR



Ölçü mm/inç	Boy mm	KISA	Boy mm	UZUN
7	28	\$2,80		
8	28	\$2,80		
10	28	\$2,80	63	\$5,40
11	30	\$2,80	63	\$5,40
12	30	\$2,80	63	\$5,40
13	30	\$2,80	63	\$5,40
14	30	\$2,80	63	\$5,40
15	30	\$3,10	63	\$5,60
16			63	\$5,60
17	32	\$3,40	63	\$6,30
18			63	\$6,80
19	32	\$3,70	63	\$6,80
5/16	28	\$3,20		
3/8	28	\$3,20		
7/16	30	\$3,20		
1/2	30	\$3,20		
9/16	30	\$3,20		
5/8	30	\$3,90		
11/16	32	\$4,10		
3/4	32	\$5,10		

1/2" SOKETLİ YILDIZ HAVALI LOKMALAR



Ölçü mm	Boy mm	KISA
36	48	\$22,80

3/4" SOKETLİ YILDIZ HAVALI LOKMALAR



Ölçü mm	Boy mm	KISA
17	51	\$18,20
19	51	\$18,20
65	85	\$141,70

1/2" SOKETLİ ALTİKÖŞE HAVALI LOKMALAR



Ölçü mm/inç	Boy mm	KISA	Boy mm	UZUN
8	38	\$2,80	78	\$5,60
9	38	\$2,80	78	\$5,60
10	38	\$2,80	78	\$5,60
11	38	\$2,80	78	\$5,60
12	38	\$2,80	78	\$5,60
13	38	\$2,80	78	\$5,60
14	38	\$2,80	78	\$5,60
15	38	\$2,80	78	\$5,60
16	38	\$2,80	78	\$5,60
17	38	\$3,00	78	\$5,60
18	38	\$3,50	78	\$6,00
19	40	\$3,50	78	\$6,20
20	40	\$3,90	78	\$6,50
21	40	\$3,90	78	\$6,40
22	42	\$4,40	78	\$7,60
23	42	\$4,80	78	\$7,90
24	44	\$4,80	78	\$7,90
25	44	\$5,30		
26	44	\$5,30	78	\$8,50
27	46	\$5,30	78	\$8,80
28	46	\$6,00	78	\$9,40
29	46	\$6,00	78	\$9,40
30	46	\$6,70	78	\$11,00
32	46	\$7,30	78	\$11,50
36	48	\$22,80	78	\$43,50
5/16	38	\$3,30	78	\$6,50
3/8	38	\$3,30	78	\$6,50
7/16	38	\$3,30	78	\$6,50
1/2	38	\$3,30	78	\$6,50
9/16	38	\$3,30	78	\$6,50
5/8	38	\$3,30	78	\$6,50
11/16	38	\$3,50	78	\$6,50
3/4	40	\$4,10	78	\$8,60
13/16	40	\$4,60	78	\$8,70
7/8	42	\$5,10	78	\$8,80
15/16	44	\$5,50	78	\$8,80
1	44	\$6,40	78	\$10,30
1.1/16	46	\$6,40	78	\$10,30
1.1/8	46	\$7,00	78	\$11,00
1.3/16	46	\$7,80	78	\$12,80
1.1/4	46	\$8,50	78	\$13,40

3/4" SOKETLİ ALTİKÖŞE HAVALI LOKMALAR



Ölçü mm/inç	Boy mm	KISA	Boy mm	UZUN
17	51	\$11,40	90	\$16,20
18	51	\$11,40	90	\$16,20
19	51	\$11,40	90	\$16,20
20			90	\$16,20
21	51	\$11,40	90	\$16,20
22	51	\$11,40	90	\$16,20
23	51	\$11,40	90	\$16,20
24	51	\$11,40	90	\$16,20
26	54	\$11,40	90	\$16,20
27	54	\$11,40	90	\$16,20
28	54	\$11,40	90	\$16,70
29	54	\$11,40	90	\$17,10
30	54	\$11,40	90	\$17,10
32	57	\$12,30	90	\$17,10
33	57	\$12,30	90	\$18,40
34	57	\$12,30	90	\$18,40
35	57	\$12,80	90	\$21,00
36	57	\$13,20	90	\$21,00
38	57	\$13,70	90	\$22,80
40			90	\$27,20
41	58	\$15,20	90	\$27,20
42	58	\$23,70	90	\$29,80
43			90	\$29,80
45			95	\$29,80
46	63	\$23,70	95	\$29,80
50	68	\$25,80	100	\$36,80
52	70	\$28,90		
55	73	\$28,90	100	\$45,50
57	73	\$35,90		
58	73	\$35,90		
60	84	\$35,90	105	\$99,20
65	85	\$46,40	105	\$132,20
70	90	\$55,10		
75	90	\$206,80		
11/16	51	\$13,60		
3/4	51	\$13,60	90	\$17,50
13/16	51	\$13,60		
7/8	51	\$13,60	90	\$17,50
15/16	51	\$13,60	90	\$17,50
1	54	\$13,60	90	\$17,50
1.1/16	54	\$14,00		
1.1/8	54	\$14,00	90	\$21,90
1.1/4	57	\$14,00	90	\$21,90
1.5/16	57	\$14,90	90	\$23,80
1.3/8	57	\$14,90	90	\$26,30
1.7/16	57	\$16,70	90	\$28,00
1.1/2	57	\$16,70	90	\$28,00
1.5/8	58	\$17,70	90	\$39,40
1.11/16	60	\$21,20		
1.3/4	63	\$25,70		
1.7/8	65	\$25,70		
2	68	\$25,70		
2.1/16	70	\$25,70		
2.1/4	73	\$25,70		

1/2" SOKETLİ ALTİKÖŞE HAVALI
MAFSALLI LOKMALAR



Ölçü mm	Boy mm	KISA
19	66	\$27,50

1" SOKETLİ ALTİKÖŞE HAVALI LOKMALAR

Ölçü mm/inç	Boy mm	KISA	Boy mm	UZUN
17	60	\$16,30	90	\$21,50
19	60	\$16,30	90	\$21,50
20			90	\$21,50
21	60	\$16,30	90	\$21,50
22	60	\$16,30	90	\$21,50
23	60	\$16,30	90	\$21,50
24	60	\$16,30	90	\$21,50
25			90	\$21,50
26	60	\$16,30	90	\$21,50
27	60	\$16,30	90	\$21,90
28	60	\$16,30	90	\$21,90
29	60	\$16,30	90	\$21,90
30	62	\$16,30	90	\$21,90
31			90	\$23,70
32	63	\$16,30	90	\$23,70
33	63	\$17,50	90	\$23,70
34	63	\$17,50	90	\$24,50
35	63	\$17,50	90	\$26,30
36	67	\$18,90	90	\$26,30
38	67	\$19,90	90	\$30,70
41	70	\$21,50	90	\$32,40
42	70	\$25,90		
46	70	\$25,90	100	\$37,40
50	70	\$30,70	100	\$44,20
52	82	\$40,90		
55	87	\$40,90	110	\$57,80
57	87	\$50,80		
58	87	\$50,80		
60	91	\$50,80	110	\$75,30
63	91	\$56,90		
65	95	\$56,90	120	\$96,20
70	100	\$77,00	125	\$122,50
75	105	\$103,20	150	\$144,30
80	105	\$118,10	150	\$165,80
85	110	\$133,80	160	\$354,70
90	110	\$164,50	160	\$367,00
95	120	\$168,80	160	\$386,90
100	120	\$174,10		
105	120	\$360,20		
110	120	\$393,60		
115	120	\$466,90		
3/4	60	\$19,20		
13/16	60	\$19,20		
7/8	60	\$19,20		
15/16	60	\$19,20		
1	60	\$19,20		
1,1/16	60	\$19,20		
1,1/8	60	\$19,20		
1,3/16	62	\$19,20		
1,1/4	63	\$19,20		
1,5/16	63	\$21,00		
1,3/8	63	\$21,00		
1,7/16	67	\$22,80		
1,1/2	67	\$22,80		
1,5/8	70	\$26,30		
1,11/16	70	\$28,90		
1,3/4	70	\$29,80		
1,13/16	70	\$31,50		
1,7/8	70	\$33,30		
2	70	\$38,50		
2,1/16	82	\$38,50		
2,1/8	82	\$41,10		
2,3/16	87	\$60,40		
2,1/4	87	\$55,10		
2,5/16	87	\$56,40		
2,3/8	91	\$51,60		
2,1/2	91	\$66,50		
2,5/8	95	\$76,10		
2,3/4	100	\$85,80		
2,7/8	100	\$131,20		
2,15/16	105	\$132,30		
3	105	\$135,80		
3,1/8	105	\$150,50		



1" SOKETLİ KARE HAVALI LOKMALAR



Ölçü mm/inç	Boy mm	KISA	Boy mm	UZUN
17	60	\$29,80		\$29,80
19	60	\$29,80		
21	60	\$29,80	90	\$29,80
22			90	\$29,80
3/4	60	\$29,80		
13/16	60	\$29,80		

1.1/2" SOKETLİ ALTİKÖŞE HAVALI LOKMALAR

Ölçü mm	Boy mm	KISA
41	80	\$183,70
46	84	\$183,70
50	84	\$194,40
55	90	\$198,60
60	90	\$206,60
65	95	\$223,00
70	100	\$245,80
75	105	\$264,40
80	110	\$302,40
85	110	\$339,10
90	112	\$369,60
95	112	\$416,20
100	115	\$451,10
105	120	\$523,30
110	124	\$531,90
115	128	\$660,10
120	132	\$661,90
125	136	\$842,30
130	140	\$1.212,90
135	145	\$1.590,80
140	150	\$2.401,20
145	155	\$2.834,80
150	160	\$3.301,70



2.1/2" SOKETLİ ALTİKÖŞE HAVALI LOKMALAR

Ölçü mm	Boy mm	KISA
125	165	\$1.604,30

1/4" SOKETLİ ALTIKÖŞE KROMAJLI LOKMALAR



Ölçü mm/inç	Boy mm	KISA	Boy mm	UZUN
8			50	\$4,90
10			50	\$4,90
1/8	25	\$2,50		
1/4	25	\$2,50	50	\$8,20
19/32	25	\$2,50		

1/2" SOKETLİ ALTIKÖŞE KROMAJLI LOKMALAR



Ölçü mm/inç	Boy mm	KISA	Boy mm	UZUN
8	38	\$3,60	78	\$14,10
9	38	\$3,60	78	\$14,10
10	38	\$3,60	78	\$14,10
11	38	\$3,60	78	\$14,10
12	38	\$3,60	78	\$14,10
13	38	\$3,60	78	\$14,10
14	38	\$3,60	78	\$14,10
15	38	\$4,90	78	\$15,20
16	38	\$4,90	78	\$15,20
17	38	\$4,90	78	\$15,20
18	38	\$4,90	78	\$15,20
19	40	\$6,40	78	\$16,10
20	40	\$6,40	78	\$16,10
21	40	\$6,40	78	\$16,10
22	42	\$6,40	78	\$16,10
23	42	\$7,40	78	\$17,70
24	42	\$7,40	78	\$17,70
26	42	\$7,40	78	\$17,70
27	42	\$7,40	78	\$17,70
28	42	\$8,90	78	\$19,20
29	42	\$8,90		
30	42	\$8,90	78	\$19,20
32	42	\$8,90	78	\$19,20
36	44	\$14,50	78	\$32,30
5/16	38	\$4,90	78	\$14,50
3/8	38	\$4,90	78	\$14,50
7/16	38	\$4,90	78	\$14,50
1/2	38	\$4,90	78	\$14,50
9/16	38	\$4,90	78	\$14,50
5/8	38	\$6,40	78	\$16,10
11/16	38	\$6,40	78	\$16,10
3/4	40	\$6,40	78	\$16,10
13/16	40	\$8,90	78	\$19,20
7/8	42	\$8,90	78	\$19,20
15/16	44	\$8,90	78	\$19,20
1	44	\$8,90	78	\$19,20
1,1/16	46	\$10,60	78	\$19,80
1,1/8	46	\$10,60	78	\$19,80
1,3/16	46	\$10,60	78	\$22,10
1,1/4	46	\$10,60	78	\$25,60

3/8" SOKETLİ ALTIKÖŞE KROMAJLI LOKMALAR



Ölçü mm/inç	Boy mm	KISA	Boy mm	UZUN
7	28	\$3,30		
8	28	\$3,30	63	\$8,40
9			63	\$8,40
10	28	\$3,30	63	\$8,40
11	30	\$3,30	63	\$8,40
12			63	\$8,40
13	30	\$3,30	63	\$8,40
14	30	\$3,30	63	\$8,40
15	30	\$4,20	63	\$9,70
16	30	\$4,20	63	\$9,70
17	32	\$4,20	63	\$9,70
18	32	\$4,20	63	\$9,70
19	32	\$4,20	63	\$9,70
1/4	28	\$4,20	63	
5/16			63	\$14,50
3/8			63	\$14,50
7/16			63	\$14,50
1/2			63	\$14,50
9/16			63	\$14,50
19/32	30	\$5,70	63	\$16,10
5/8			63	\$16,10
11/16			63	\$16,10
3/4			63	\$16,10
25/32	32	\$6,40	63	\$19,20
13/16	32	\$6,40	63	\$19,20
7/8	32	\$6,40	6	\$19,20

1/2" SOKETLİ YILDIZ KROMAJLI LOKMALAR



Ölçü mm/inç	Boy mm	KISA	Boy mm	UZUN
8			78	\$14,10
10			78	\$14,10
13	38	\$3,60	78	\$14,10
14	38	\$3,60	78	\$14,10
17	38	\$4,90	78	\$15,20
19	40	\$6,40	78	\$16,10
22			78	\$19,20
24			78	\$19,20
27	46	\$7,40	78	\$19,20
30	46	\$8,90	78	\$19,20
32			78	\$19,20
1/2			78	\$14,50
9/16			78	\$14,50
11/16			78	\$16,10
3/4			78	\$16,10
13/16			78	\$19,20
15/16			78	\$19,20
1			78	\$19,20
1,1/8			78	\$19,20

3/4" SOKETLİ ALTIKÖŞE KROMAJLI LOKMALAR



Ölçü mm/inç	Boy mm	KISA	Boy mm	UZUN
17	51	\$16,10		
19	51	\$16,10		
22	51	\$16,10		
24	51	\$16,10	90	\$25,60
36	57	\$19,20		
50	68	\$41,60		
52	71	\$48,00		
55	75	\$48,00		
58	78	\$56,00		
60	80	\$56,00		
65	85	\$87,90		
70	90	\$103,90		
3/4	51	\$16,10		
15/16	51	\$16,10		
1,1/8	54	\$31,90		
1,1/4	57	\$31,90		
1,5/16	57	\$31,90		
1,3/8	57	\$31,90		
1,7/16	57	\$31,90		
1,1/2	57	\$35,20		
1,5/8	58	\$35,20		
1,3/4	63	\$40,10		
1,7/8	65	\$40,10		
2,1/16	70	\$40,10		
2,3/16	73	\$56,00		
2,1/4	73	\$56,00		
2,5/16	73	\$56,00		
2,3/8	80	\$56,00		
2,1/2	80	\$56,00		
2,5/8	85	\$73,50		
2,3/4	90	\$73,50		

1" SOKETLİ ALTIKÖŞE KROMAJLI LOKMALAR



Ölçü mm/inç	Boy mm	KISA
36	67	\$61,30
38	67	\$61,30
41	70	\$61,30
43	70	\$61,30
46	70	\$61,30
50	70	\$63,80
54	82	\$67,10
55	87	\$67,10
58	87	\$79,90
60	91	\$79,90
63	91	\$87,90
65	95	\$87,90
70	100	\$103,90
75	105	\$111,80
80	105	\$127,60
85	110	\$183,60
90	110	\$231,50
95	120	\$306,30
100	120	\$382,80
105	120	\$510,40
110	120	\$558,40
115	120	\$630,20
2,1/4	87	\$95,70
2,5/16	87	\$95,70
2,3/8	91	\$103,90
2,7/16	91	\$111,80
2,1/2	91	\$111,80
2,5/8	95	\$112,10
2,3/4	100	\$127,60
3,1/8	105	\$207,50

3/4" SOKETLİ YILDIZ KROMAJLI LOKMALAR

Ölçü mm/inç	Boy mm	KISA
17	51	\$16,10
19	51	\$16,10
50	68	\$48,00
54	73	\$48,00
55	73	\$48,00
58	73	\$56,00
60	80	\$56,00
65	85	\$114,90
70	90	\$114,90
1"	54	\$16,10
1,1/8	54	\$31,90
1,1/4	57	\$31,90
1,5/16	57	\$31,90
1,3/8	57	\$31,90
1,7/16	57	\$31,90
1,1/2	57	\$35,20
1,5/8	58	\$35,20
1,3/4	63	\$40,10
1,13/16	63	\$40,10
1,7/8	65	\$40,10
2	68	\$40,10
2,1/4	73	\$56,00
2,5/8	85	\$73,50



1" SOKETLİ YILDIZ KROMAJLI LOKMALAR

Ölçü mm/inç	Boy mm	KISA
36	67	\$72,00
38	67	\$79,90
41	70	\$79,90
46	70	\$95,70
50	70	\$111,80
55	87	\$127,60
60	91	\$127,60
65	95	\$153,20
70	100	\$153,20
75	105	\$175,60
80	105	\$239,40
85	110	\$287,10
90	110	\$350,90
95	120	\$382,80
2,1/4	87	\$143,70
2,3/8	91	\$143,70
2,5/8	95	\$175,60
2,3/4	100	\$175,60
3,1/8	105	\$335,10

