

## KOMBİNE ANAHTAR TAKIMI



7 -19mm 11.p	HS-011M	\$48,80
m7-8-9-10-11-12-13-14-15-17-19		

1/4"-7/8" 11.p	HS-011S	\$71,00
1/4-5/16-3/8-7/16-1/2-9/16-5/8-11/16-3/4-13/16-7/8		

## KOMBİNE ANAHTAR TAKIMI



6-32mm 24.p	HS-024M	\$173,80
m6-7-8-9-10-11-12-13-14-15-16-17-18-19-20-21-22-23-24 25-26-27-30-32		

6-32mm 26.p	PR-026M	\$251,90
m6-7-8-9-10-11-12-13-14-15-16-17-18-19-20-21-22-23-24 25-26-27-28-29-30-32		

6-32mm 16.p	HS-016M	\$132,30
m6-7-8-9-10-11-12-13-14-17-19-22-24-27-30-32		

6-22mm 17.p	PR-017M	\$100,20
m6-7-8-9-10-11-12-13-14-15-16-17-18-19-20-21-22		

5/16"-1" 11.p	PR-011S	\$112,80
5/16-3/8-7/16-1/2-9/16-5/8-11/16-3/4-7/8-15/16-1"		

1/4"-1,1/4" 16.p	HS-016S	\$125,10
1/4-5/16-3/8-7/16-1/2-9/16-5/8-11/16-3/4-13/16-7/8 15/16-1-1,1/16-1,1/8-1,1/4		

1/4"-1,1/4" 16.p	PR-016S	\$154,40
1/4-5/16-3/8-7/16-1/2-9/16-5/8-11/16-3/4-13/16-7/8 15/16-1-1,1/16-1,1/8-1,1/4		

## CIRCIRLI KOMBİNE ANAHTAR TAKIMI



8-19mm 8.p	GW-7608M	\$95,00
m8-10-11-12-13-14-17-19		

8-19mm 11.p	GW-7611M	\$137,90
m8-10-11-12-13-14-15-16-17-18-19		

5/16"-3/4" 8.p	GW-7708S	\$111,40
5/16-3/8-7/16-1/2-9/16-5/8-11/16-3/4		

## CIRCIRLI KOMBİNE ANAHTAR TAKIMI



8-19mm 7.p	WRGCM7	\$89,00
m8-10-12-13-14-17-19		

## CIRCIRLI KOMBİNE ANAHTAR TAKIMI



8-32mm  
17.p

GW-7617M

\$350,00

m8-10-11-12-13-14-15-16-17-18-19-21-22-24-27-30-32

## MAFSALLI CIRCIRLI KOMBİNE ANAHTAR TAKIMI



8 -19mm  
8.p

GFP-7608M

\$109,00

m8-10-12-13-14-15-17-19

## YILDIZ ANAHTAR TAKIMI

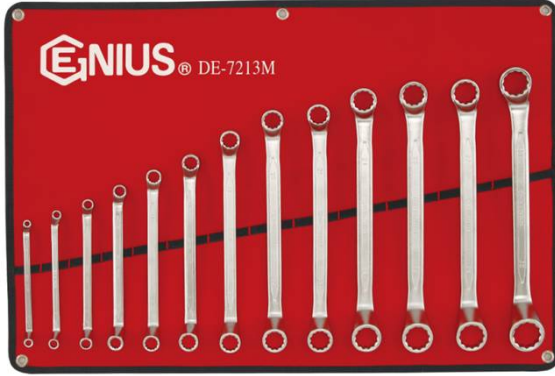

6-22mm MAT  
8.p

DE-7208M

\$82,20

m6x7-8x9-10x11-12x13-14x15-16x17-18x19-20x22

6-32mm MAT  
13.p

DE-7213M

\$189,60

m6x7-8x9-10x11-12x13-14x15-16x17-18x19-20x22  
21x23-24x26-25x28-27x29-30x32

6-32mm  
13.p

DE-713M

\$242,10

m6x7-8x9-10x11-12x13-14x15-16x17-18x19-20x22  
21x23-24x26-25x28-27x29-30x32

1/4"-1.1/8"  
8.p

DE-708S

\$145,70

1/4x5/16-3/8x7/16-1/2x9/16-5/8x11/16-3/4x13/16  
7/8x15/16-1x1.1/16-1.1/8x1.1/4

## İKİ AĞIZLI ANAHTAR TAKIMI



6-22mm  
8.p

OW-708M

\$47,40

m6x7-8x9-10x11-12x13-14x15-16x17-18x19-20x22

6-32mm  
13.p

OW-713M

\$97,50

m6x7-8x9-10x11-12x13-14x15-16x17-18x19-20x22  
21x23-24x26-25x28-27x30-30x32

1/4"-1.1/4"  
9.p

OW-709S

\$72,90

1/4x5/16-3/8x7/16-1/2x9/16-5/8x11/16-3/4x7/8  
13/16x7/8-15/16x1-1x1.1/8-1.1/16x1.1/4

## TORX ANAHTAR TAKIMI



E.6-E.24  
4.p

TX-E04

\$40,40

6x8-10x12-14x18-20x24

## KOMBİNE ANAHTAR



Ölçü	Boy/mm	
24mm	320	\$12,60
27mm	370	\$16,80
28mm	360	\$17,40
30mm	410	\$19,50
32mm	430	\$20,90
34mm	461	\$29,30
35mm	461	\$39,30
36mm	486	\$39,30
38mm	486	\$46,00
41mm	540	\$49,80
46mm	611	\$56,30
50mm	611	\$64,80
55mm	666	\$154,20
60mm	760	\$202,60
65mm	760	\$202,60

## CIRCIRLI KOMBİNE ANAHTAR

Ölçü	Boy/mm	
8mm	135	\$9,30
9mm	142	\$9,40
10mm	158	\$10,20
11mm	167	\$10,20
12mm	173	\$11,10
13mm	179	\$11,40
14mm	189	\$12,00
15mm	199	\$12,30
16mm	215	\$13,50
17mm	232	\$13,50
18mm	238	\$14,00
19mm	247	\$15,00
20mm	285	\$22,70
21mm	285	\$23,30
22mm	285	\$23,30
24mm	325	\$28,80
27mm	355	\$36,50
28mm	355	\$44,70
30mm	425	\$44,70
32mm	425	\$44,70



Ölçü	Boy/mm	
17mm	128	\$13,50

## KAYNAKÇI TİPİ AYARLI PENSE



9" - 225mm	533309LW	\$29,30
------------	----------	---------

## UZUN AĞIZLI TİP AYARLI PENSE

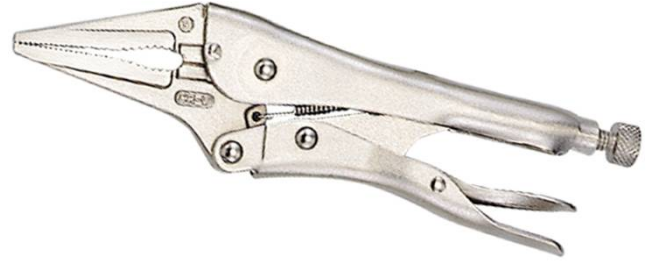

6" - 150mm	531306LN	\$15,40
------------	----------	---------

## KESKİ ZIMBA TAKIMI



14.p	PC-514M	\$48,80
------	---------	---------

5 Keski-2 Nokta zimba-5 Pim zimba-2 Uzun pim zimba

## AYARLI PENSE



5" - 125mm	530305A	\$16,30
------------	---------	---------

7" - 175mm	530307A	\$20,90
------------	---------	---------

10" - 250mm	530310A	\$20,90
-------------	---------	---------

## MEKANİK (EL) GRES POMPASI

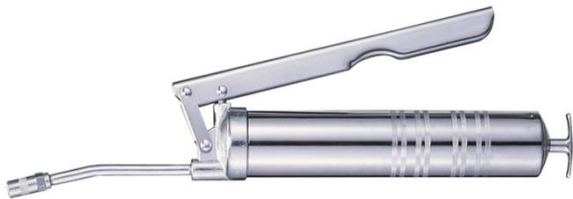

500cc	AT-46012	\$27,90
-------	----------	---------

## LOKMA ANAHTAR STANDI



1/4" - 410mm 15 Klips	010152	\$8,20
--------------------------	--------	--------

3/8" - 480mm 15 Klips	010153	\$8,20
--------------------------	--------	--------

1/2" - 560mm 15 Klips	010154	\$9,30
--------------------------	--------	--------

## MANYETİK STAND



305mm / 12"	005012	\$18,60
-------------	--------	---------

405mm / 16"	005016	\$22,00
-------------	--------	---------

## BORU ANAHTARI



12" - 300mm	782300	\$38,30
-------------	--------	---------

14" - 350mm	782350	\$46,20
-------------	--------	---------

18" - 460mm	782460	\$65,10
-------------	--------	---------

24" - 600mm	782610	\$99,20
-------------	--------	---------

36" - 900mm	782910	\$153,60
-------------	--------	----------

48" - 1200mm	783220	\$344,80
--------------	--------	----------

## SAC MAKASI



10" - 250mm Sağ	511002R	\$19,80
--------------------	---------	---------

## İZOLELİ KARGABURUN



6" - 150mm	550604S	\$17,10
------------	---------	---------

6" - 150mm	550604D	\$17,10
------------	---------	---------

8" - 200mm	550804D	\$19,50
------------	---------	---------

## KURBAĞACIK



4" - 100mm	780128	\$15,10
------------	--------	---------

6" - 150mm	780192	\$15,10
------------	--------	---------

8" - 200mm	780256	\$16,80
------------	--------	---------

10" - 250mm	780320	\$22,30
-------------	--------	---------

12" - 300mm	780384	\$29,30
-------------	--------	---------

15" - 380mm	780480	\$59,40
-------------	--------	---------

18" - 450mm	780576	\$105,40
-------------	--------	----------

24" - 600mm	780692	\$219,30
-------------	--------	----------

## TOPUKLU KEÇE LEVYESİ



561116	\$14,00
--------	---------

Boy

405mm

## İZOLELİ PENSE



7" - 175mm	551712S	\$22,60
------------	---------	---------

7" - 175mm	551712D	\$22,60
------------	---------	---------

## İZOLELİ FORT PENSE



10" - 250mm	551011D	\$27,40
-------------	---------	---------

## İZOLELİ YANKESKİ



6" - 150mm

550607D

\$21,60

## DÜZ İÇ SEGMAN PENSESİ



7" - 175mm

550751

\$22,10

## EĞRİ İÇ SEGMAN PENSESİ



7" - 175mm

550753

\$22,10

## DÜZ DIŞ SEGMAN PENSESİ



7" - 175mm

550750

\$22,10

## EĞRİ DIŞ SEGMAN PENSESİ



7" - 175mm

550752

\$22,10

## POP PERÇİN PENSESİ



SC-715

\$31,40

2,4 - 3,2 - 4 - 4,8mm

## KOLLU POP PERÇİN PENSESİ



SC-714

\$51,10

3,2 - 4 - 4,8 - 6,4mm

## SOMUNLU PERÇİN PENSESİ



SC-758A

\$66,20

3 - 4 - 5 - 6mm

## KOLLU SOMUNLU PERÇİN PENSESİ



SC-785M

\$192,60

5 - 6 - 8 - 10mm

## SAATÇI TORNAVİDA TAKIMI



6.P	TL-506	\$16,30
-----	--------	---------

Düz:0,4x2-0,4x2,5-0,5x3  
Yıldız:Ph000-00-0

6.P	TL-506A	\$16,30
-----	---------	---------

Düz:0,3x1,2-0,3x1,6-0,4x2  
Yıldız:Ph000-00-0

## BİTS UÇ TAKIMI



1/4"- Arkalı 34.p	SC-234A	\$32,50
----------------------	---------	---------

Allen uç (6)-Düz uç (6)-Yıldız uç (3)-Torx uç (7)  
Delikli torx uç (7)-Kare uç (3)-Uç sapı (1)-Adptör (1)

1/4"- Arkalı 37.p	SC-237M	\$32,50
----------------------	---------	---------

Allen uç (6)-Düz uç (6)-Yıldız uç (6)-Torx uç (7)  
Delikli torx uç (7)-Yıldız allen uç (3)-Uç sapı (1)-Adptör (1)  
Düz:0,3x1,2-0,3x1,6-0,4x2  
Yıldız:Ph000-00-0

## LOKMA TORNAVİDA TAKIMI

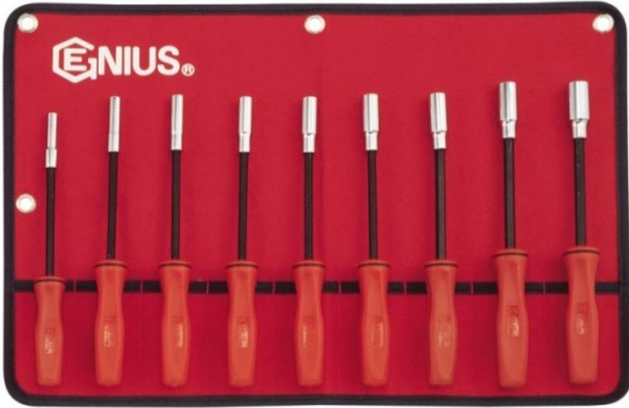

6-14mm 9.p	NM-009MD	\$89,40
---------------	----------	---------

m6-7-8-9-10-11-12-13-14

1/4"- 1/2" 6.p	NM-006SD	\$89,40
-------------------	----------	---------

1/4-5/16-11/32-3/8-7/16-1/2

# TURNUS

## İŞKENCE



420-028	28x25mm	€ 31,20
420-053	53x38mm	€ 38,70
420-078	78x50mm	€ 46,50
420-105	105x60mm	€ 60,80
420-130	130x70mm	€ 78,80
420-155	155x76mm	€ 87,40
420-206	206x86mm	€ 112,00

## OTOMATİK İŞKENCE



472-012	120x60mm	€ 52,70
472-016	160x80mm	€ 57,50
472-020	200x100mm	€ 66,70
472-025	250x120mm	€ 76,40
472-030	300x140mm	€ 90,80
472-040	400x120mm	€ 95,40
472-050	500x120mm	€ 102,20
472-060	600x120mm	€ 106,30
472-080	800x120mm	€ 128,40
472-100	1000x120mm	€ 142,60

## OTOMATİK İŞKENCE



485-010	100x80mm	€ 48,10
485-020	200x80mm	€ 53,20

## İŞKENCE



473-020	200x120mm	€ 98,50
473-025	250x120mm	€ 100,60
473-030	300x120mm	€ 106,30
473-040	400x120mm	€ 113,00
473-050	500x120mm	€ 120,60
473-060	600x120mm	€ 125,20

## ALLEN TORNAVİDA



171S-0,7mm	60-140mm	€ 8,90
171S-0,9mm	60-140mm	€ 8,90
171S-1,3mm	60-140mm	€ 8,90
171S-1,5mm	60-140mm	€ 8,90

# TURNUS

## AYARLI PENSE



690-125

125mm

€ 28,90



691-250

250mm

€ 39,70



692-250

250mm

€ 57,10

## CONTA KESME PERGELİ



321-200

Tek Bıçak  
200mm

€ 69,80

321-400

Tek Bıçak  
400mm

€ 81,20

321-600

Tek Bıçak  
600mm

€ 94,80

322-200

Çift Bıçak  
200mm

€ 106,80

322-400

Çift Bıçak  
400mm

€ 120,10

322-600

Çift Bıçak  
600mm

€ 138,60

## SAC MAKASI



978-300

300mm Sağ

€ 50,20

978-301

300mm Sol

€ 50,20



# AMERICAN TOOLS - IRVIN

## WR - STANDART TİP AYARLI PENSE



4"-100mm

4 WR

\$21,20

5"-125mm

5 WR

\$21,20

10"-250mm

10 WR

\$24,10

## RR - DÜZ BIÇAK AĞIZLI TİP AYARLI PENSE



7"-175mm

7 RR

\$36,10

## LN - UZUN AĞIZLI TİP AYARLI PENSE



6"-150mm

6 LN

\$30,80

## AC - KAYNAKÇI TİP AYARLI PENSE



9"-225mm

9 AC

\$43,70

## LW - SOMUN İÇİN AYARLI PENSE



10"-250mm

10LW

\$25,30

## R - KİLİTLİ TİP ZİNCİRLİ BORU ANAHTARI



9"-225mm

20 R

\$43,70

## SP - C TİPİ MAFSALLI AĞIZLI AYARLI PENSE



\$24,10

# AMERICAN TOOLS - IRVIN

## R - C TİPİ STANDART AĞIZLI AYARLI PENSE



6"-150x50mm

6 R

\$24,10

11"-275x100mm

11 R

\$31,70

18"-455x200mm

18 R

\$46,70

## GJP- FORT PENSE



10"-250mm

10 GJP

\$34,70

12"-300mm

12 GJP

\$40,70

## GLGJP- KİLİTLİ TİP FORT PENSE



10"-250mm

10 GLGJP

\$54,20

12"-300mm

12 GLGJP

\$67,70

## SAC MAKASI



9,1/2"-240mm

20 SL

\$39,10

## TEL KESKİSİ



7,1/2"-190mm

Yumuşak çelik:6,5mm-Sert çelik: 5mm

Çelik parça:4mm

Yay çeliği:2,5mm-Elektrik kablosu:6,5mm

6TWC

\$67,70

## KUYUMCU MAKASI



Tipi Düz-Yaysız  
Boy 180mm

85-40851810

€ 17,20

## ELEKTRONİKÇİ YANKESKİ



Tipi Yaylı  
Boy 120mm

180E-41180070

€ 35,00

## KUYUMCU MAKASI



Tipi Düz-Yaylı  
Boy 180mm

85F-40851820

€ 19,00

## ELEKTRONİKÇİ KARGABURUN



Tipi Yaylı  
Boy 120mm

183E-41183070

€ 24,60

## KUYUMCU MAKASI



Tipi Eğri  
Boy 180mm

87-40871860

€ 21,40

## İĞNE PENSESİ

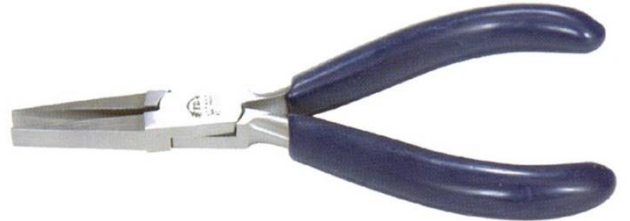

Tipi Düz  
Boy 180mm

40151280

€ 29,20

## DÜZ SAATÇİ TORNAVİDA TAKIMI



Düz ağızlı 6 parçalı takım

40918000-918

€ 22,30

# EASTMAN

## İZOLELİ PENSE

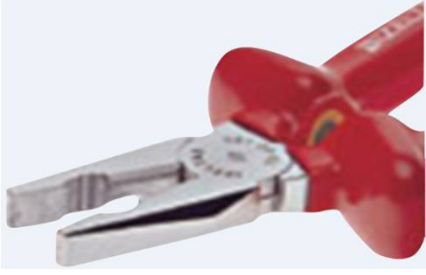

6" - 150mm

\$3,30

7" - 180mm

\$4,30

8" - 200mm

\$4,40

## İZOLELİ YANKESKİ



6" - 150mm

\$3,70

7" - 180mm

\$3,90

## İZOLELİ KARGABURUN



6" - 150mm

\$3,70

7" - 180mm

\$3,90

8" - 200mm

\$4,00

## İZOLELİ KERPETEN



6" - 160mm

\$3,70

10" - 250mm

\$4,20

## STİLSON TİPİ BORU ANAHTARI



14" - 350mm

\$7,00

18" - 450mm

\$12,60

24" - 600mm

\$23,10

## DEMİR TESTERE KOLU



10 adet Yedeği ile

\$5,00

## KOMBİNE ANAHTAR TAKIMI



6-32mm / 12'li

\$18,70

## AĞIR TİP BORU ANAHTARI



14" - 350mm

\$14,30

## EL GRES POMPASI

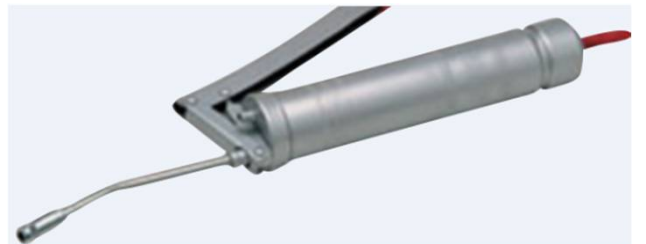

500cc

\$20,90

# LASER

## 3/8" SOKETLİ AÇIK AĞIZ ANAHTAR TAKIMI



Soket	3/8"
Parça sayısı	10
Muhteviyatı	m10-11-13-14-15 16-17-18-19-22

3282

€ 85,00

# RECORD

## STİLSON TİPİ BORU ANAHTARI



300/10	10" - 250mm	€ 17,60
300/12	12" - 300mm	€ 20,90
300/14	14" - 350mm	€ 24,20
300/18	18" - 450mm	€ 35,20
300/24	24" - 600mm	€ 52,80